

BEFORE YOU BEGIN

Read these instructions and check to be sure all parts and tools are accounted. Please retain these installation instructions for future reference.

IMPORTANT

This AUDIO PORTABLE SYSTEM SUPPORT BASE KIT is exclusively designed for your vehicle. Please read the installation instructions thoroughly before beginning. Installation is easier if the vehicle is clean and free of debris.

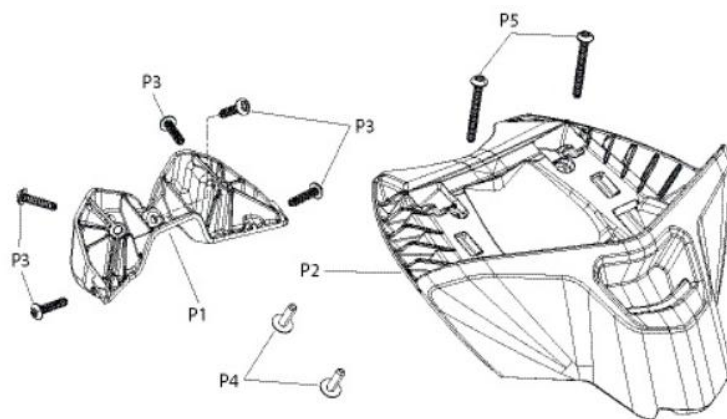

1. Retaining screw

INSTALLATION INSTRUCTIONS

Shift vehicle transmission into "PARK". Turn key to "OFF" position and remove from vehicle.

- 1. Remove front trim (if applicable).
- 1.1. Open the front cover by pulling on the two latches.

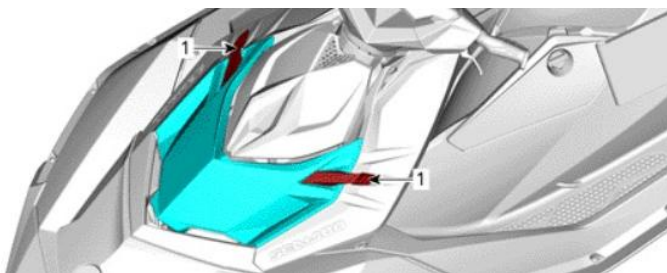

1. Latch

- 1.2. Remove the retaining screw.

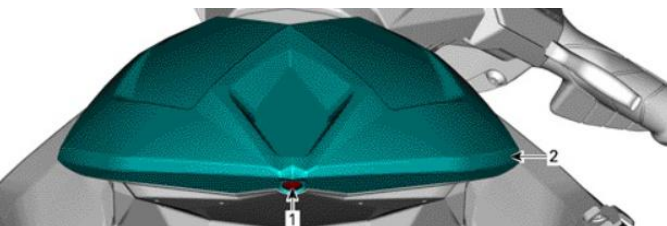

- 1.3. Unclip the front trim from the vehicle.

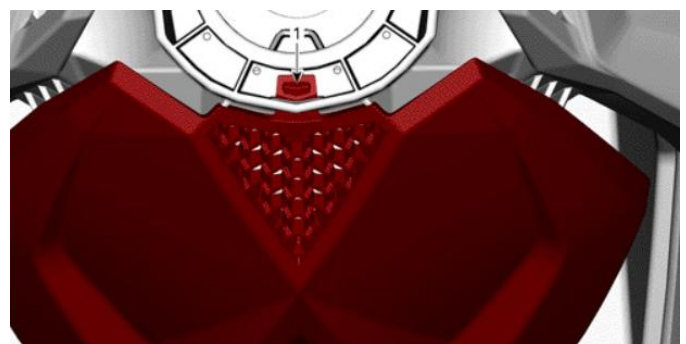

- 2. Mark and drill the front trim according to the following image.

Audio-Portable System Support Base For Sea-Doo

SAUTV⁵

ZP-YJ-030603-149

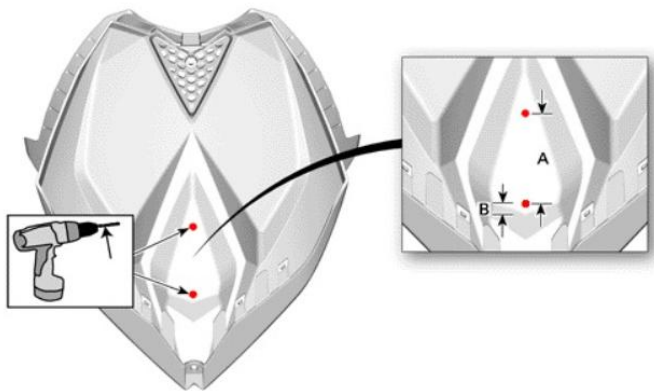

3. Position the audio system anchor [P2] on the front trim. Mark locations shown, remove the audio system anchor [P2] and drill two 20 mm (13/16 in) holes in the front trim.



4. Position the anchor support [P1] on the vehicle, mark the five location shown and remove the anchor support [P1].

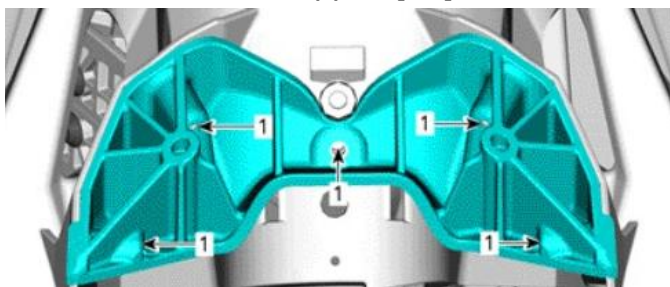

1. Mark location

5. Drill holes in the body according to specification.

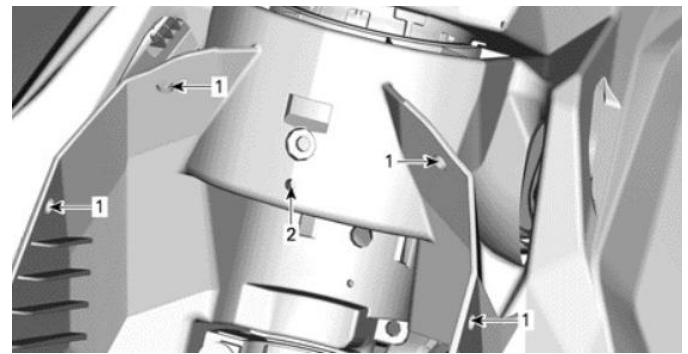

1. Drill size T1

2. Drill size T2

6. Fix the five M6.81x30 Torx screw [P3] as shown starting from the middle one. (NOTICE: Do not use power tools to tighten screws.)

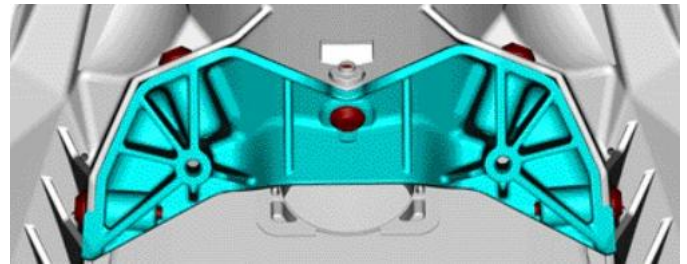

7. Fix the audio system anchor [P2] on the front trim with two M6.81 x 25 Hexagonal cap screw [P4].

(NOTICE: Do not use power tools to tighten screws.)

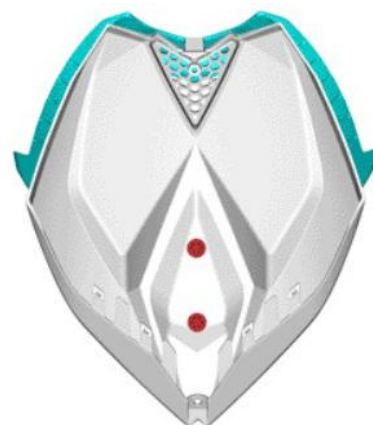

8. Install this assembly on the vehicle. Clip the front trim on the vehicle, reinstall the front trim retaining screw and fix the assembly with two M6.81x60 Torx screw [P5] as shown.

(NOTICE: Do not use power tools to tighten screws.)

Audio-Portable System Support Base For Sea-Doo

ZP-YJ-030603-149

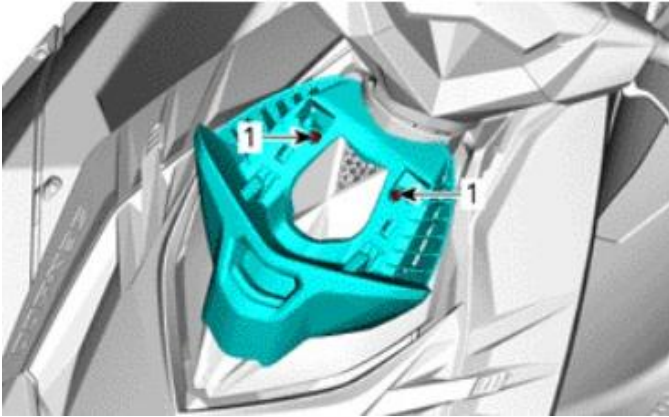

1. M6.81 x 60 Torx screw [P5]