

Front Access Cover For Sea-Doo Spark

ZP-YJ-030603-145

SAUTV5

BEFORE YOU BEGIN

Read these instructions and check to be sure all parts and tools are accounted. Please retain these installation instructions for future reference.

IMPORTANT

This FRONT ACCESS COVER KIT is exclusively designed for your vehicle. Please read the installation instructions thoroughly before beginning. Installation is easier if the vehicle is clean and free of debris.

INSTALLATION INSTRUCTIONS

1. Shift vehicle transmission into "PARK". Turn key to "OFF" position and remove from vehicle.
2. Product image.



3. The original access cover of the yacht will be removed, and then replaced with a new access cover, and finally lock the switch valve.

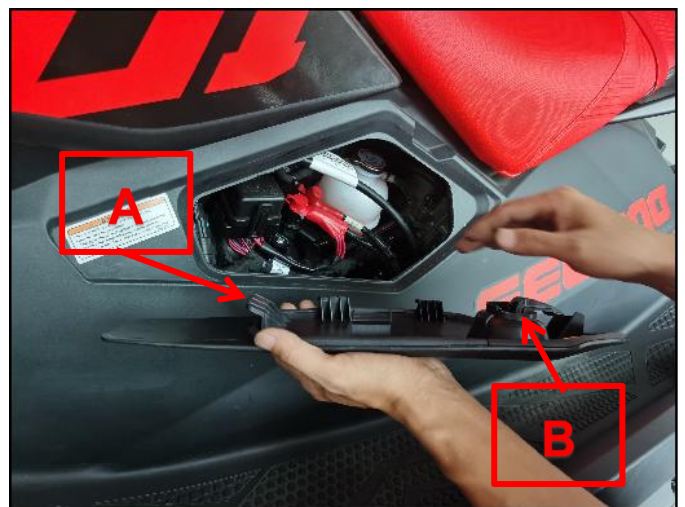

Front Access Cover For Sea-Doo Spark

ZP-YJ-030603-145

SAUTVS®



4. Installation completed.

