

# Snorkel Kit Horn For Can-Am Outlander XMR

SAUTV5®

ZP-YJ-030603-139

## BEFORE YOU BEGIN

Read these instructions and check to be sure all parts and tools are accounted. Please retain these installation instructions for future reference.

## IMPORTANT

This SNORKEL KIT HORN is exclusively designed for your vehicle. Please read the installation instructions thoroughly before beginning. Installation is easier if the vehicle is clean and free of debris.

## INSTALLATION INSTRUCTIONS

1. Shift vehicle transmission into "PARK". Turn key to "OFF" position and remove from vehicle.

### CONSOLE SUPPORT

1. Console support cutting template C1

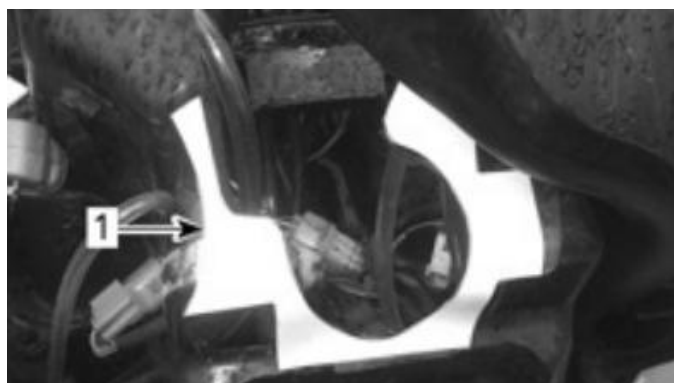
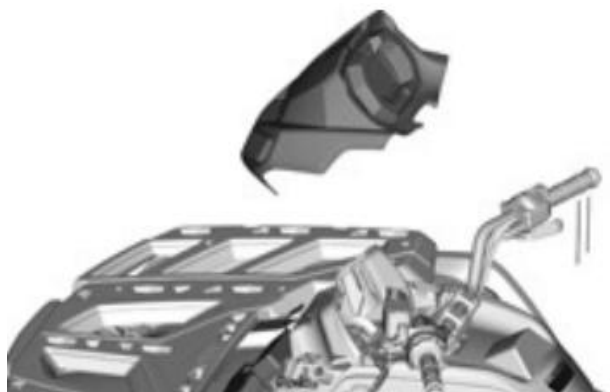

# Snorkel Kit Horn For Can-Am Outlander XMR



ZP-YJ-030603-139

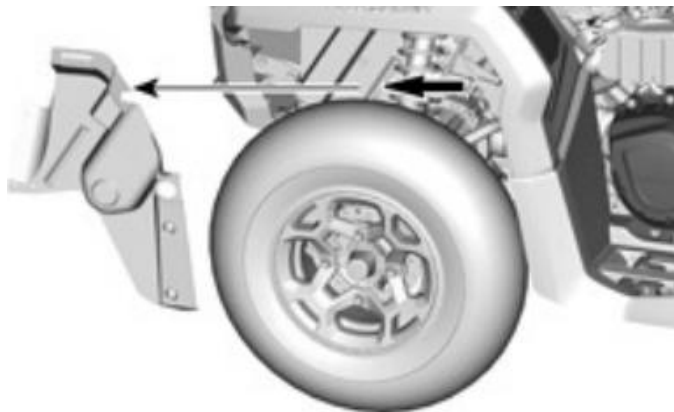
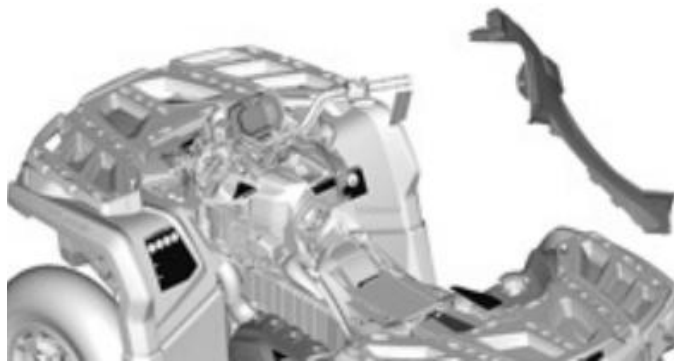
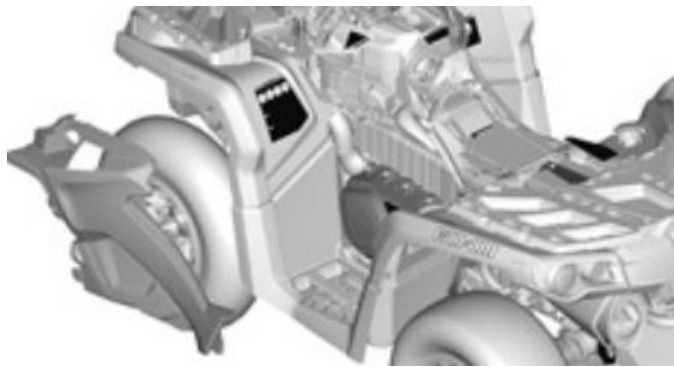

## AIR FILTER COVER

1. 2012 and older
2. 2013 and newer

## Engine Air Intake Installation.

Before installing the air inlet pipe, check the position of the air inlet pipe docking with the original vehicle, then pull out the air inlet pipe on the original vehicle, cut off the excess pipe, put in the steel pipe at the cut end (do not put in all the steel pipe, you need to leave half of it outside for subsequent installation to fix the air inlet pipe), and finally use the steel hoop to fix it, and then install it back in place.

## Engine Air Intake.

Original Equipment Removal.

(NOTE: On XMR MODELS, only the [P2] needs to be installed. All other parts are factory installed. Remember that equipment removal and illustration may be different.)

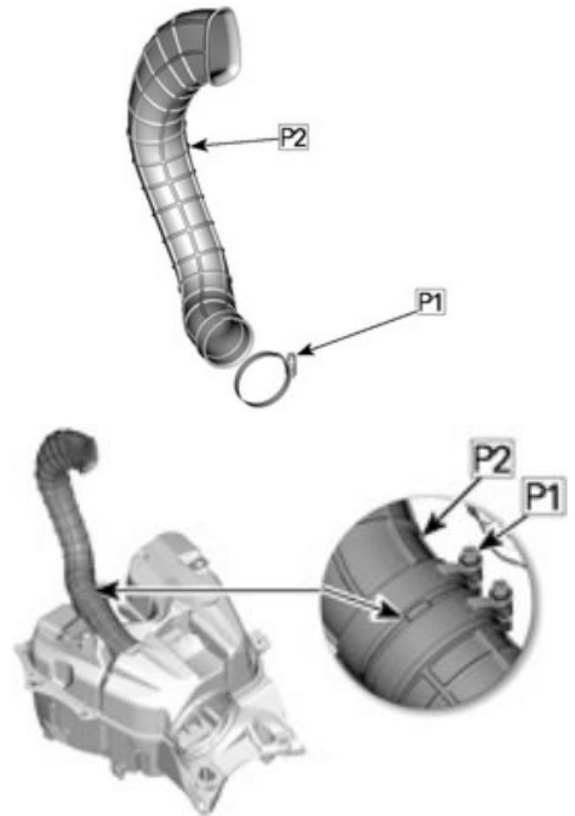
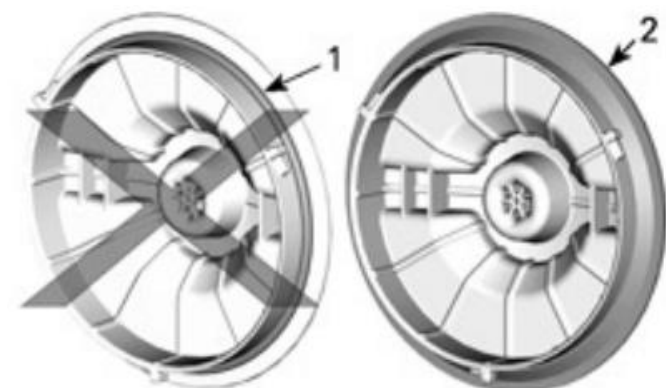

Torque screw clamp to  $2.5 \pm .5 \text{ N}\cdot\text{m}$  ( $22 \pm 4 \text{ lbf}\cdot\text{in}$ ).



# Snorkel Kit Horn For Can-Am Outlander XMR



ZP-YJ-030603-139

## Console and Console Cover

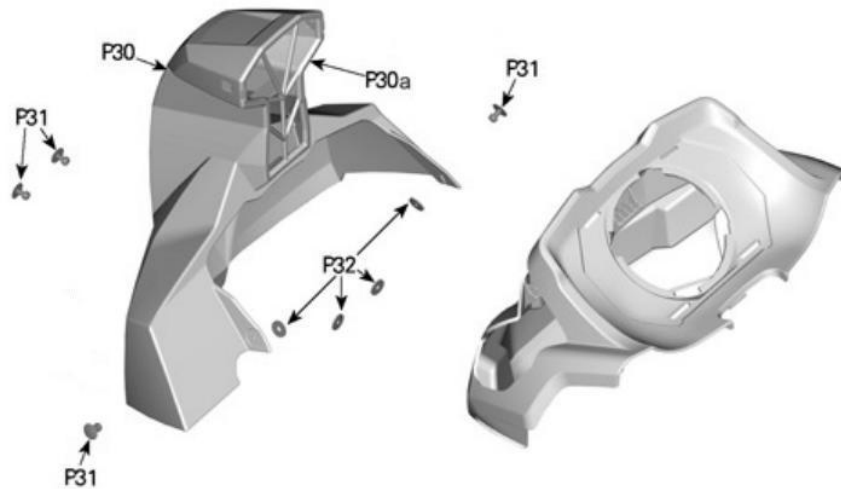

1. It is recommended to remove instrument gauge before cutting console.

C2 AND C3 TEMPLATES FOR NEW GAUGE SUPPORT

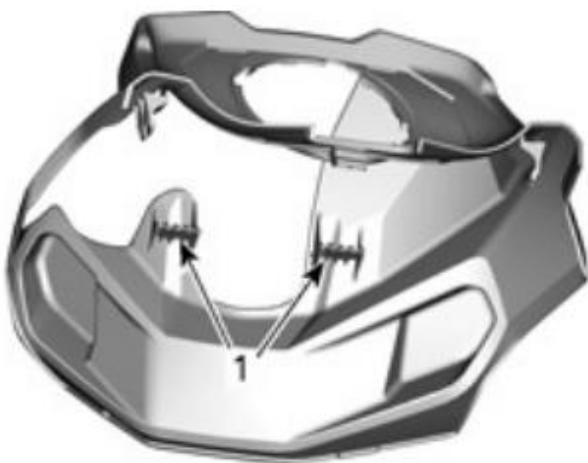

TYPICAL - INSIDE CONSOLE

1. Locating tabs

2. If you order a new gauge support, use the C2 template for the center hole and the C3 template for the LH hole.

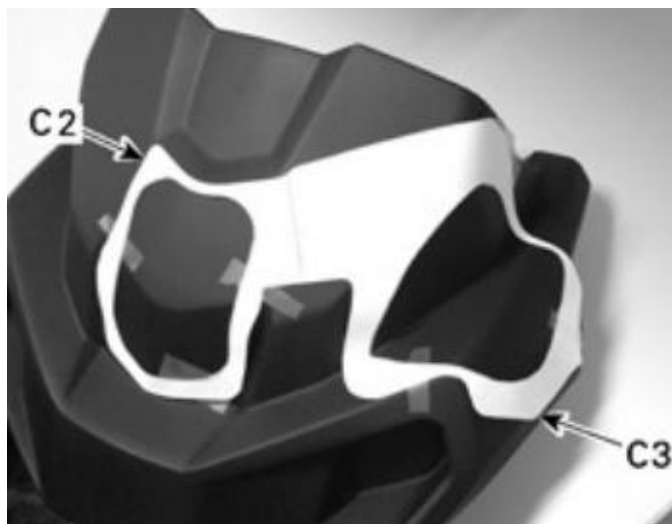

NEW GAUGE SUPPORT AFTER CUTOUT

3. If you re-use the existing Xmr gauge support, use the C4 template for the center hole.

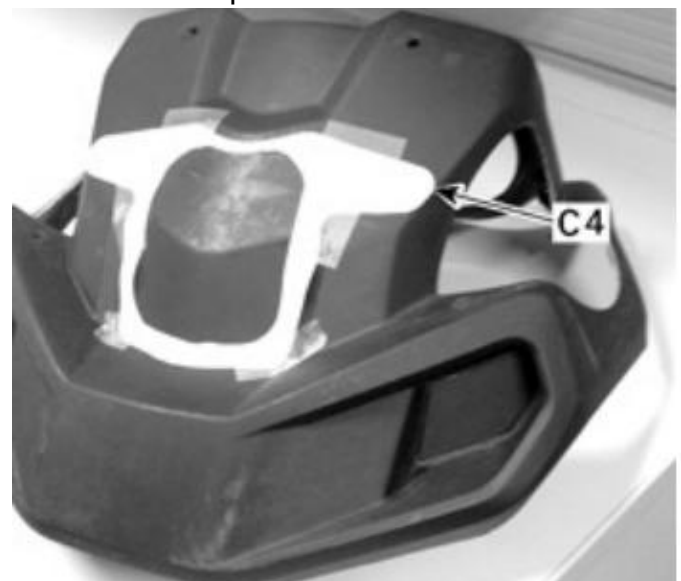

C3 TEMPLATE FOR EXISTING GAUGE SUPPORT

# Snorkel Kit Horn For Can-Am Outlander XMR

ZP-YJ-030603-139



EXISTING GAUGE SUPPORT AFTER CUTOUT

## End Installation

Install all removed parts.

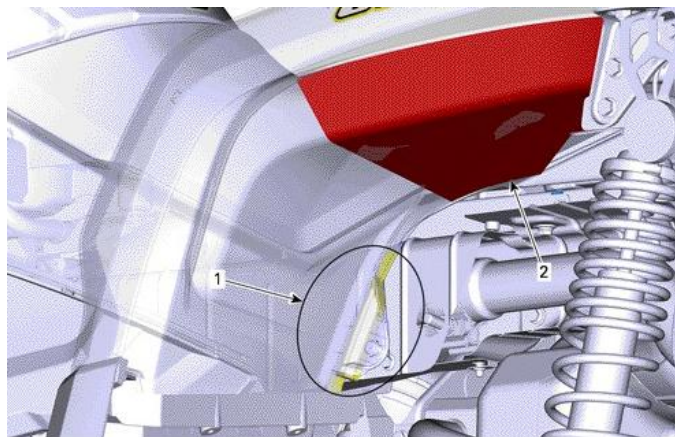

1.DRILL 5 MM (13/64 IN)

PROTECTOR SHIELDS LOCATION

