

Windshield Fairing for Polaris Sportsman XP 1000

ZP-YJ-030503-101



BEFORE YOU BEGIN

Read these instructions and check to be sure all parts and tools are accounted for. Please retain these installation instructions for future reference.

IMPORTANT

This Windshield Fairing is exclusively designed for your vehicle. Please read the installation instructions thoroughly before beginning. Installation is easier if the vehicle is clean and free of debris.

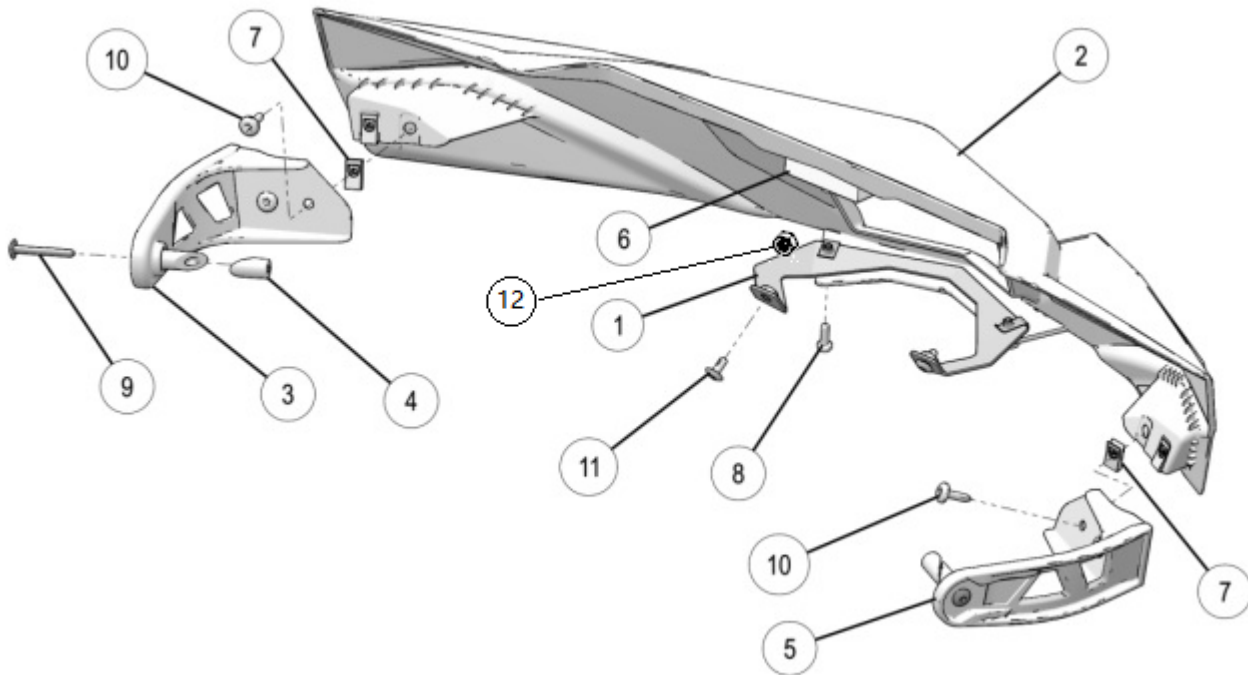

INSTALLATION INSTRUCTIONS

1. Shift vehicle transmission into "PARK". Turn key to "OFF" position and remove from vehicle.
2. Remove the front pod cover (A) by removing four screws (B) using T25 Torx® as shown.

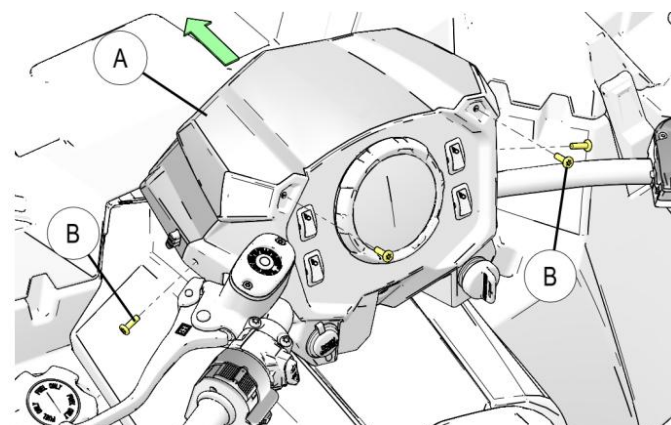

3. Place template (C) available on last page of

instructions on lower surface of front pod cover (A) and mark two hole locations on front pod cover as shown. Drill holes into marked locations using 1/4" drill bit.

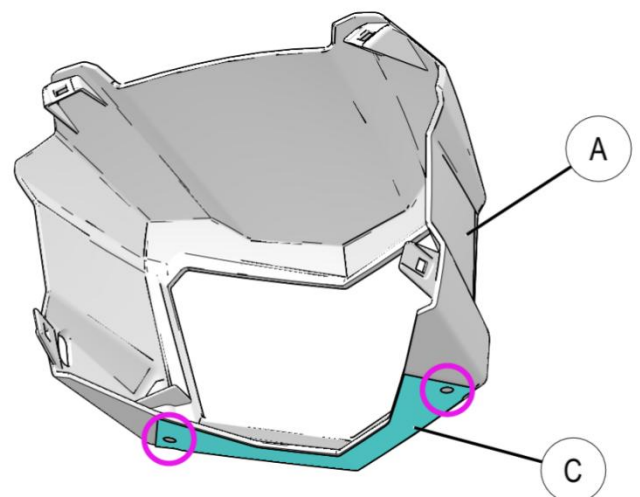

4. Attach two U clip speed nuts (7) to fairing

Windshield Fairing for Polaris Sportsman XP 1000

ZP-YJ-030503-101



support bracket (1) and mount fairing support bracket (1) onto headlight bracket by installing two screws (11) and two nuts (12). Tighten screws (11) to nuts (12) to fix fairing support bracket (1).

Note: If your headlight bracket does not have mounting holes, follow Step 5 for fairing bracket (1) installation.

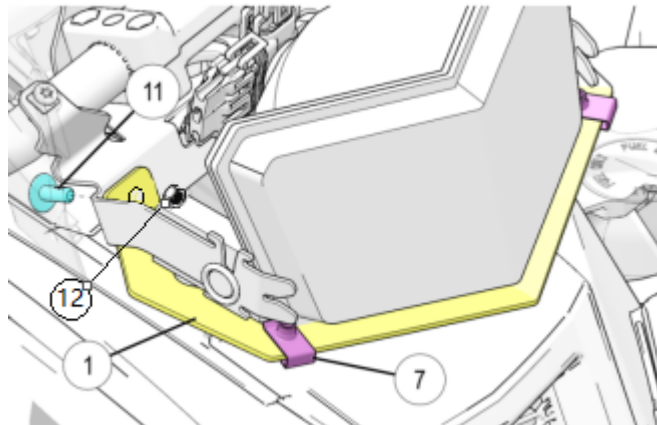

5. Line up the fairing support bracket (1) with headlight bracket (G) as shown and mark the two hole locations (F) on headlight bracket (G). Remove the headlight and set aside. Drill two 1/4" holes (H) in locations marked using drill bit. Reinstall headlight and install fairing support bracket (1) per instructions in Step 4.

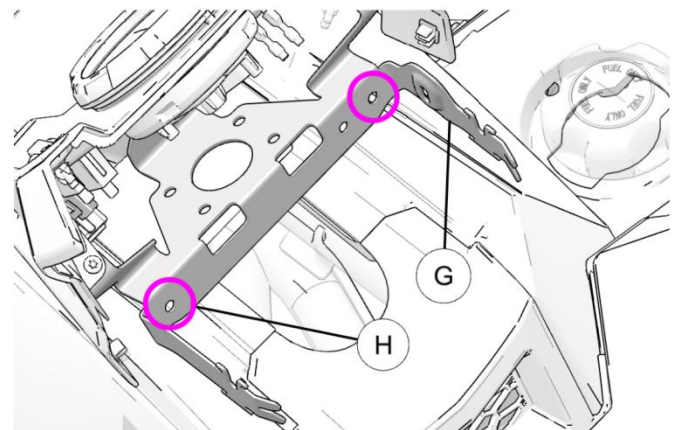
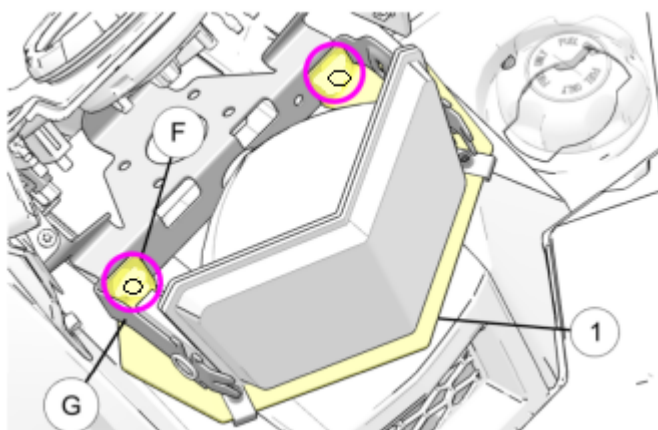

6. Reinstall front pod cover (A) back onto the vehicle using screws (B) removed in Step 2. Tighten screws just until snug.

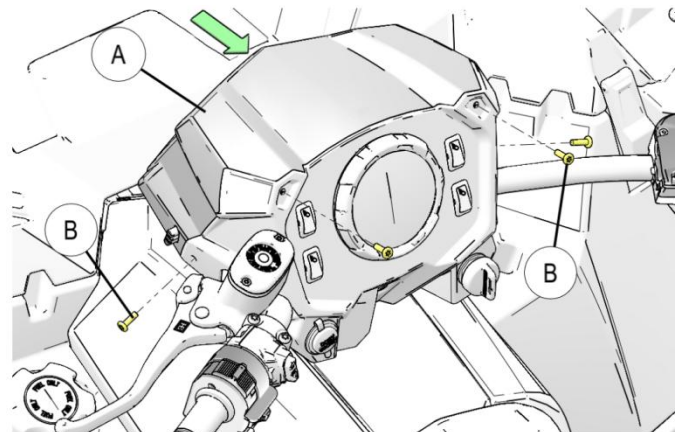

7. Install main fairing mounts (3) (5) on both sides of the windshield fairing (2) by aligning holes and installing U-clip speed nuts (7) and screws (10) as shown. Tighten screws to specification.

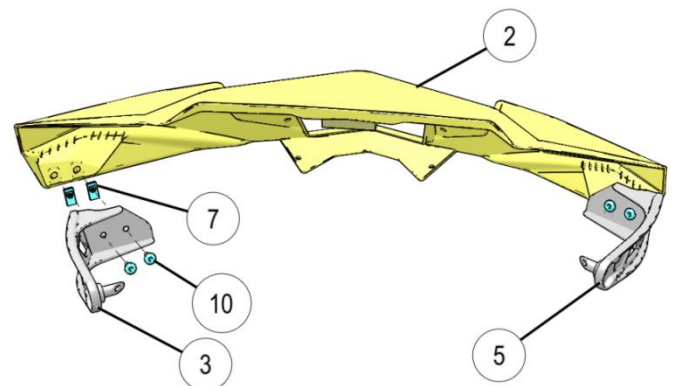

8. Loosely install slider fairing mounts (4) onto main fairing mounts (3) (5) using screws (9) on both sides as shown.

Windshield Fairing for Polaris Sportsman XP 1000

ZP-YJ-030503-101

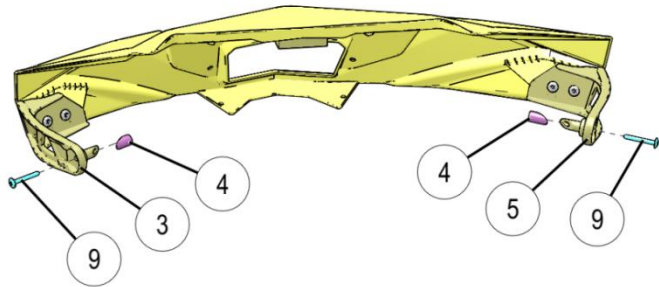

9. Cut the end of grips (C) (highlighted in yellow) on both sides of handlebar using knife or razor blade for fairing mounts (3) and (5) installation.

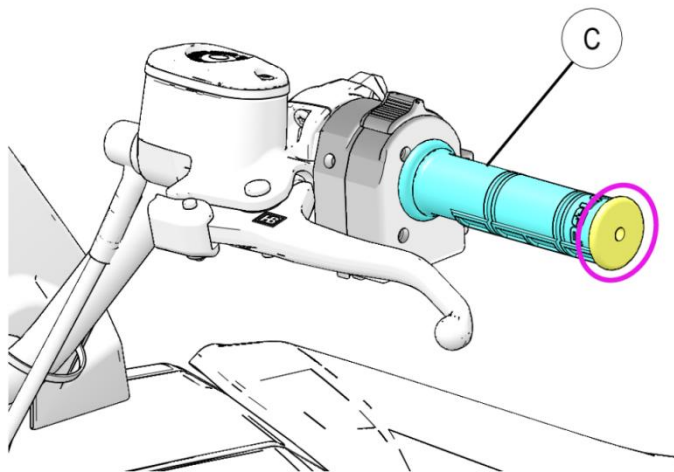

10. Install windshield fairing (2) onto the handlebar by inserting end of the fairing mounts (3) (5) with previously installed slider mounts (4) inside the handlebar openings as shown. Do not tighten fairing mount screws (9) at this stage.

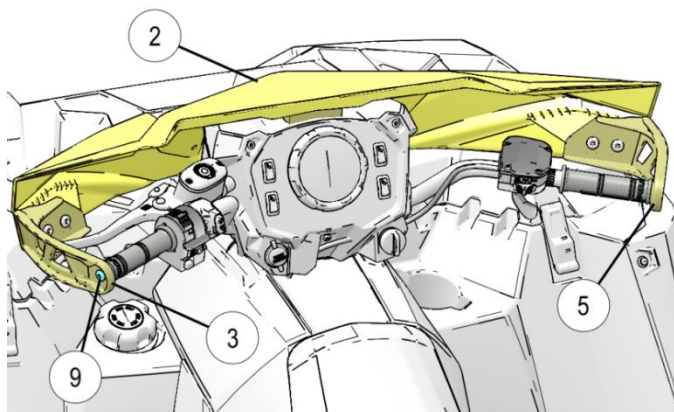

11. Align two holes on lower side of windshield fairing (2) with previously drill holes on pod cover (A) and holes on fairing support bracket (1) and install two screws (8) as shown. Tighten screws to specification.

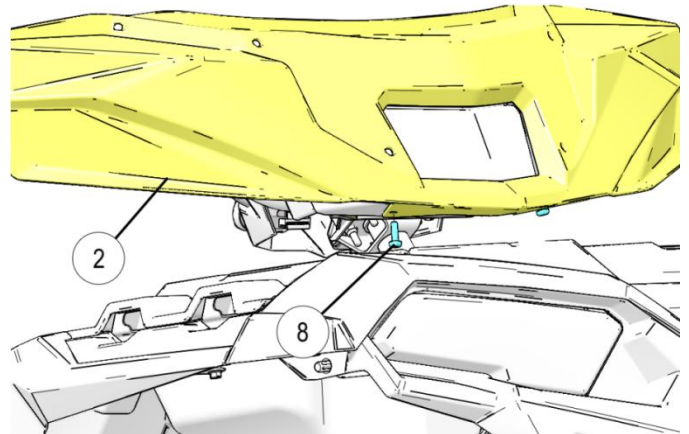

12. Tighten fairing mount screws (9) on both sides of handlebar at this time to specification. Installation of fairing kit is completed.

13. Install windshield (D) on your windshield fairing (2) by aligning mounting holes and inserting six push darts (E) as shown.

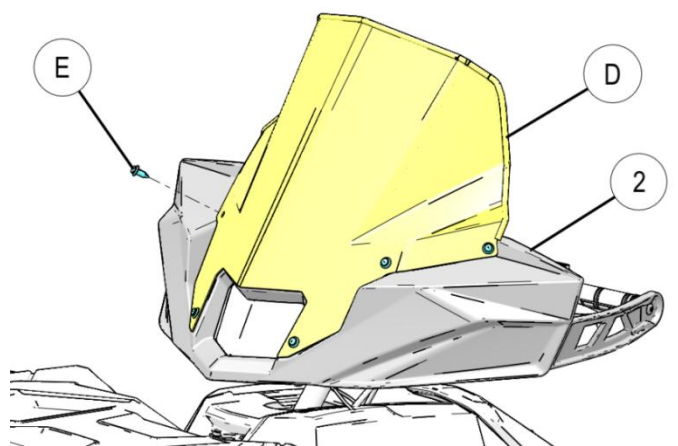

Template

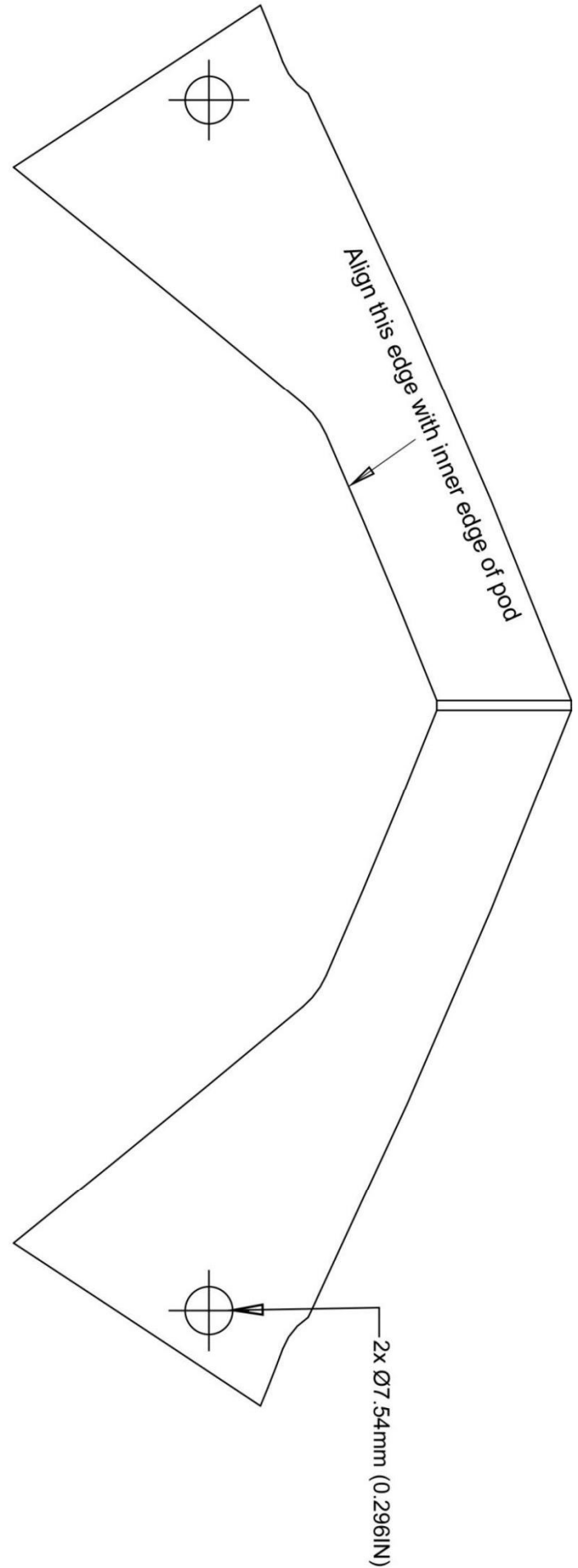

Note: If printing from electronic file and template is not at proper 1:1 scale, then ensure print settings indicate "Actual Size" (not "Fit").