

# Front Bumper for Polaris RZR PRO R

ZP-YJ-030506-028



## BEFORE YOU BEGIN

Read these instructions and check to be sure all parts and tools are accounted for. Please retain these installation instructions for future reference.

## IMPORTANT

The Front Bumper are exclusively designed for your vehicle. Please read the installation instructions thoroughly before beginning. Installation is easier if the vehicle is clean and free of debris. For your safety, and to ensure a satisfactory installation, perform all installation steps correctly in the sequence shown.

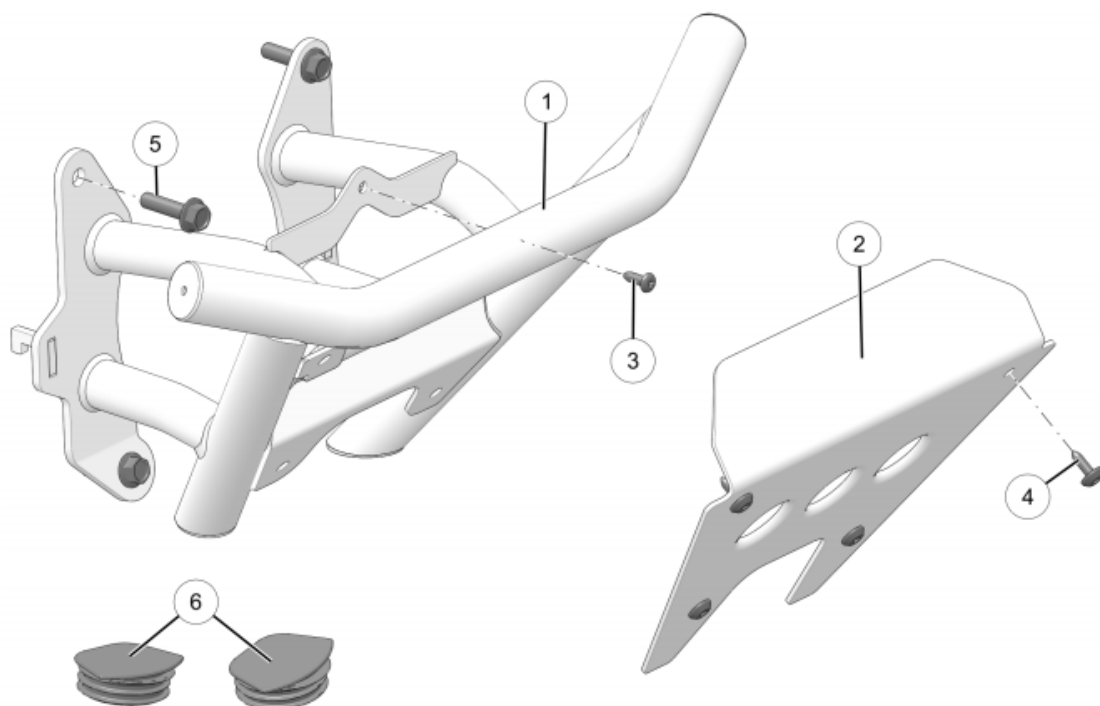

## TOOLS REQUIRED

- Safety Glasses
- Socket Set, Metric
- Pliers, Push Pin Rivet
- Socket Set, Torx Bit
- Screwdriver Set, Torx
- Torque Wrench

## INSTALLATION INSTRUCTIONS

Note: Shift vehicle transmission into "PARK". Turn key to "OFF" position and remove from vehicle.

### FRONT FASCIA REMOVAL

1. Remove two top mounting fasteners (longer) and two bottom mounting fasteners (shorter) to remove front fascia from vehicle.

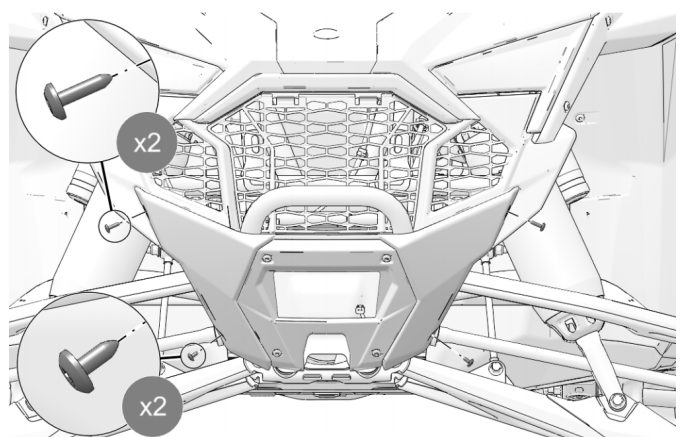

### BUMPER COVER REMOVAL

1. Remove four cover fasteners to remove bumper cover from front fascia.

# Front Bumper for Polaris RZR PRO R

ZP-YJ-030506-028

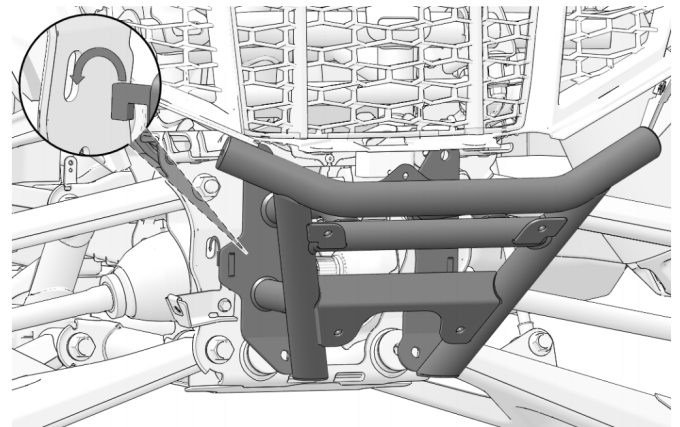
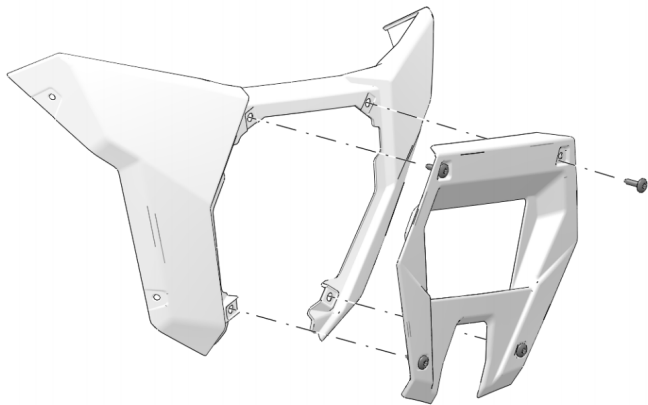

## BUMPER REMOVAL

1. Remove two push-pin rivets from front fascia.

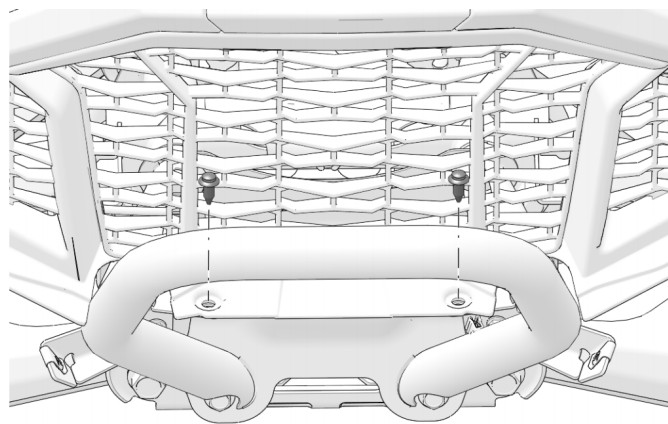

2. Remove four bumper fasteners to remove bumper assembly from chassis.

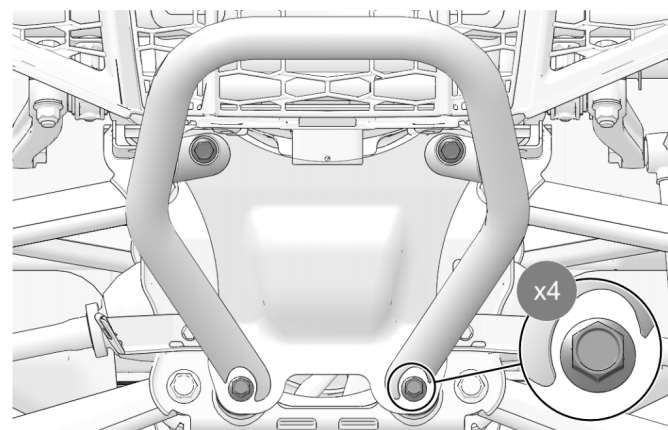

## ACCESSORY INSTALLATION

1. Align bumper with slots in front mounting plate. Insert hooks and carefully lower bumper until hooks engage with mounting plate.

2. Install bumper to mounting plate with four bumper fasteners 5.

TORQUE: Bumper Fasteners 5: 37 ft-lbs (50 N·m)

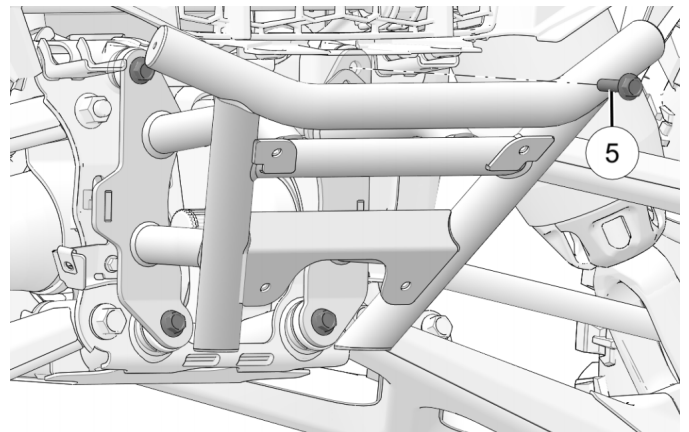

3. Secure front fascia to top of bumper with one fastener 3.

TORQUE: Bumper Fasteners 3: 30 in-lbs (3 N·m)

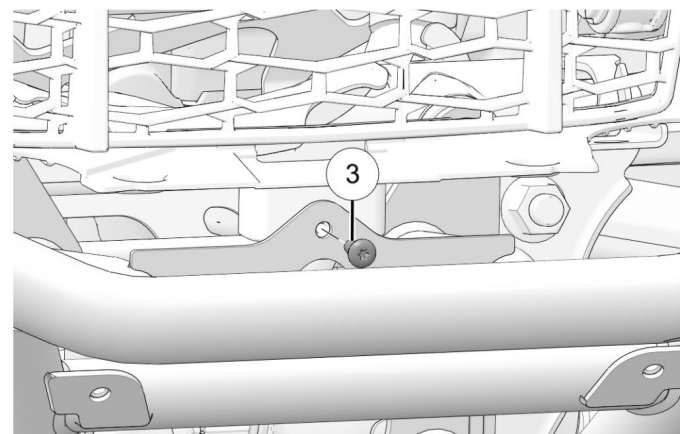

4. Install bumper plate to bumper with four plate fasteners 4.

TORQUE: Bumper Fasteners 5: 7 ft-lbs (10 N·m)

# Front Bumper for Polaris RZR PRO R

ZP-YJ-030506-028

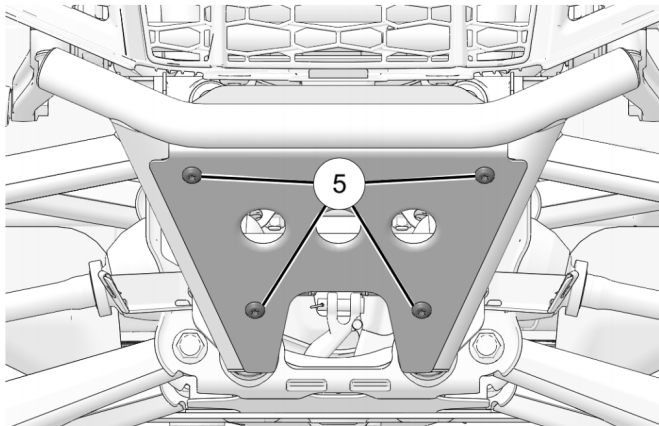

5. Reinstall front fascia panel to installed position.

**Tip:** Fascia is flexible and can be carefully bent when installing over accessory bumper.

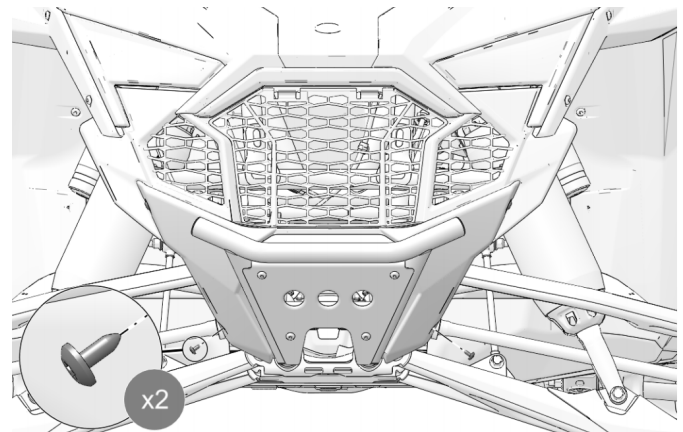

8. Install two fascia plugs 6 where original bumper was located.

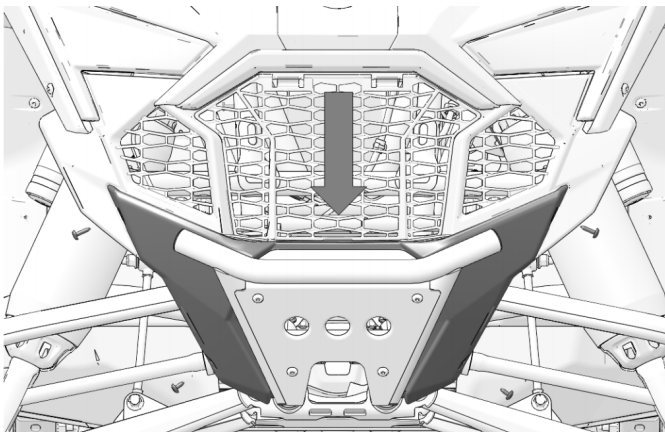

6. Reinstall top front fascia with kept fasteners (longer).

**TORQUE:** Top Fascia Fasteners (Longer):  
7 ft-lbs (10 N·m)

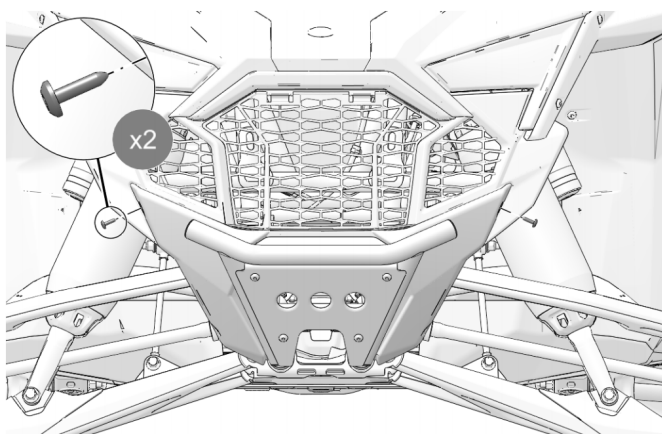
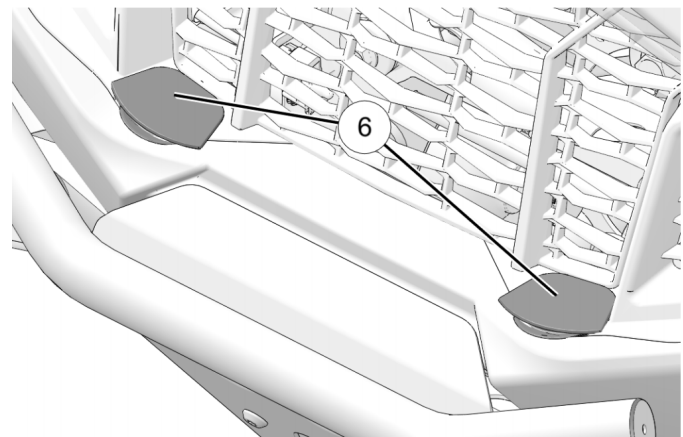

7. Reinstall bottom front fascia with kept fasteners (shorter).

**TORQUE:** Bottom Fascia Fasteners (Shorter):  
7 ft-lbs (10 N·m)