

### BEFORE YOU BEGIN

Read these instructions and check to be sure all parts and tools are accounted for. Please retain these installation instructions for future reference.

### IMPORTANT

The LED headlights is exclusively designed for your vehicle. Please read the installation instructions thoroughly before beginning. Installation is easier if the vehicle is clean and free of debris. For your safety, and to ensure a satisfactory installation, perform all installation steps correctly in the sequence shown.

### INSTRUCTIONS INSTRUCTIONS

#### PART 1: Installation on 2021+ Commander

Note: Shift vehicle transmission into "PARK". Turn key to "OFF" position and remove from vehicle.

1. Remove the cover of the machine and remove 2 the fixing screws and decorative plates on both sides.



2. Remove the 8 screws that secure the front bar.



3. Remove the front bar, remove the front net and the net lamp (the screws on both sides of the net need to be removed).

ZP-YJ-030601-001



4. Remove all wiring harness plugins from the original headlights and remove the original headlights.

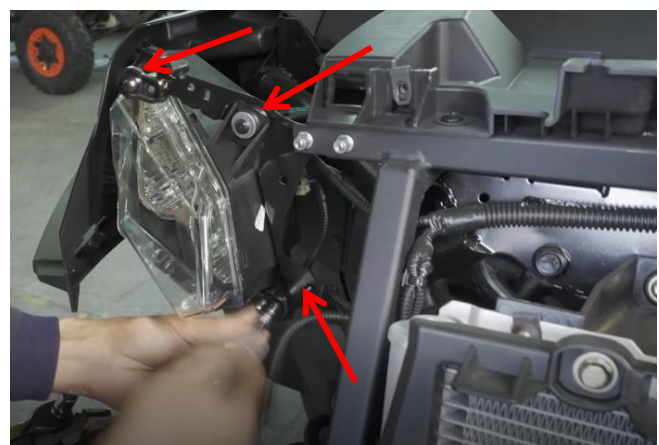

5. Install the screw rod from the original light and the rubber pad from the mounting hole onto the LED headlight.



6. Install the LED headlight back to the headlight bracket in the way previously removed, and connect the corresponding wiring harness plug-in (install the other side according to the same steps).



7. Installation is complete.



# LED Headlights for Can-Am Trail Sport / 2021+ Commander



ZP-YJ-030601-001

## PART 2: Installation on Can-Am Trail Sport

Note: Shift vehicle transmission into "PARK". Turn key to "OFF" position and remove from vehicle.

1. Remove the cover of the machine and remove the 4 fixing screws and decorative plates on both sides.



2. Remove the 10 screws that secure the front bar, and remove the front bar.



3. Remove wiring harness plugins from the original headlights and remove the entire bumper.

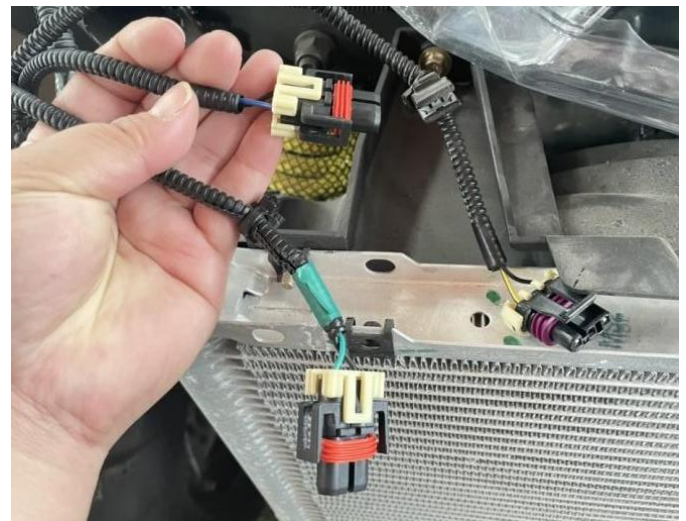

4. Remove the original lights protective shell from the back of the removed bumper, remove the light and replace it with the LED headlight (install the other side according to the same steps).

## ZP-YJ-030601-001



5. Take out the headlight adapter line in the accessories package, connect plug-in 1 with the socket of the rear housing of the lamp, and plug-in 2 with the original light line (this harness is a low beam, which is inserted with the plug marked with green protective tube on the vehicle. After docking, start the vehicle, check whether the line is normally powered on, and check whether the light type corresponding to the light and the harness is consistent), and connect plug-in 3 with the original light line (this harness is a high beam. After docking, start the car to check whether the line is normally powered on and whether the light type corresponding to the harness is consistent.) Note: when testing line 3, be sure to pull out the plug-in of the low beam harness to prevent short circuit. Plug back the low beam harness after there are no abnormalities.

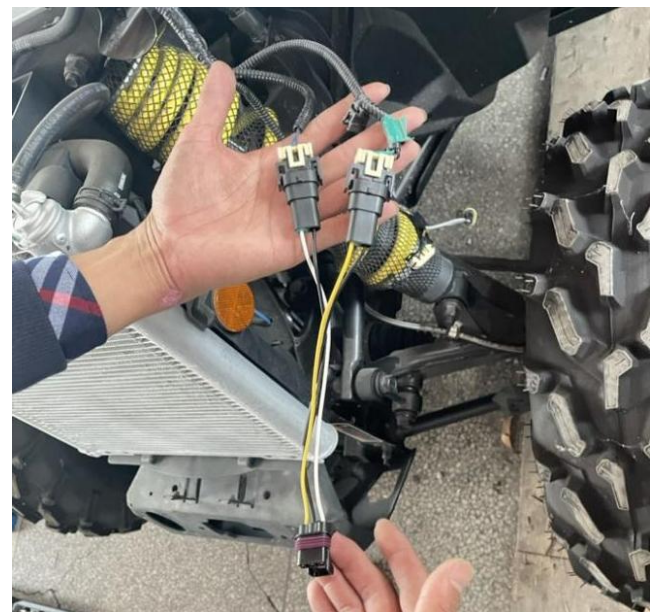

6. Install the LED headlight back to the original position and fix it according to the previous removal method (Note: the stainless steel flat pad and rubber ring of the original light must be used when fixing the screw). After that, install the front bar, covers and decorative plates on both sides.

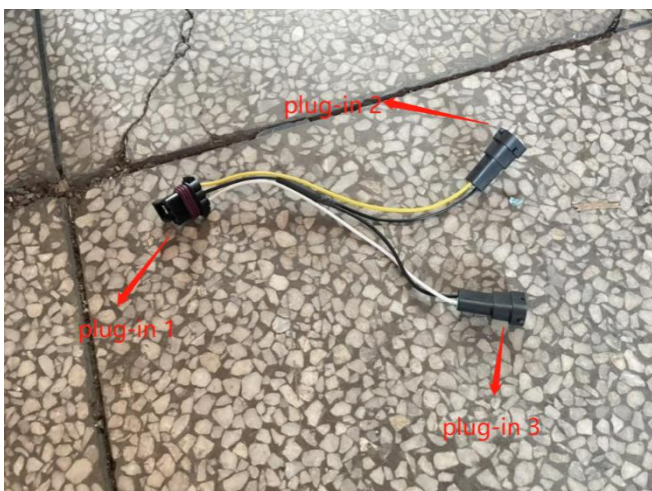

# LED Headlights for Can-Am Trail Sport / 2021+ Commander

ZP-YJ-030601-001



7. Installation is complete.

