

# LinQ Pivoting Rack For Can-Am Maverick X3

SAUTV<sup>®</sup>

ZP-YJ-030603-087

## BEFORE YOU BEGIN

Read these instructions and check to be sure all parts and tools are accounted. Please retain these installation instructions for future reference.

## IMPORTANT

This LINQ PIVOTING RACK KIT is exclusively designed for your vehicle. Please read the installation instructions thoroughly before beginning. Installation is easier if the vehicle is clean and free of debris.



## INSTALLATION INSTRUCTIONS

1. Shift vehicle transmission into "PARK". Turn key to "OFF" position and remove from vehicle.  
2. Assemble the two (2) upper cage attachments, place bushing [P11] inside the holding adaptor [P28] and use grease to facilitate rotation. Place two (2) o-ring [P12] on both side and insert all in the cage attachment [P30]. Fix the assembly with M8 X 50 screw [P13] and M8 nut [P17] and hand tighten in the middle of the adjustment slots.

3. Install M6 X 10 socket head screw [P26] on the LinQ support [P29] and tighten. Assemble LinQ [P5] on the LinQ support [P29] and use four (4) M5 X 20 screws [P20] and four (4) M5 nuts [P21] and hand tighten.

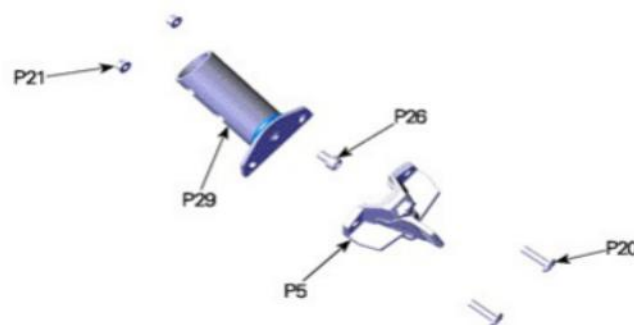
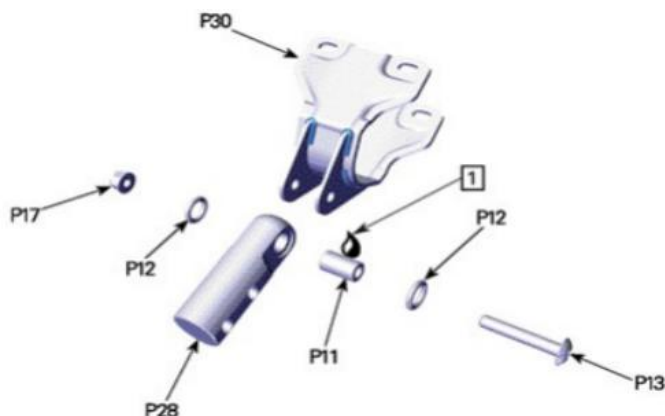

**NOTE:** Repeat same assembly with RH LinQ [P6].

4. Install cargo rack tube [P2] on the cargo rack [P3] with two (2) M6 X 35 torx screws [P24] and two (2) M6 elastic flange nuts [P19] and place cargo rack tube [P1] on the cargo rack without screws.

# LinQ Pivoting Rack For Can-Am Maverick X3

ZP-YJ-030603-087

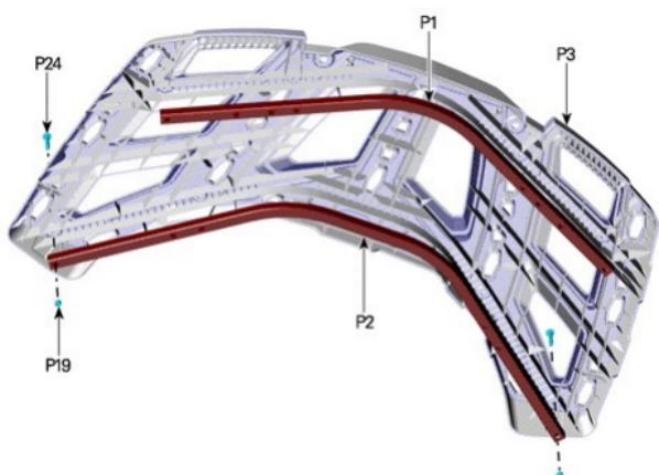

5. Assemble the cargo rack [P3] on the cargo rack frame [P27] with one (1) M6 X 65 torx screw [P23], one (1) insert [P22], one (1) M6 X 35 torx screw [P24] and one (1) M6 elastic flange nut [P19].

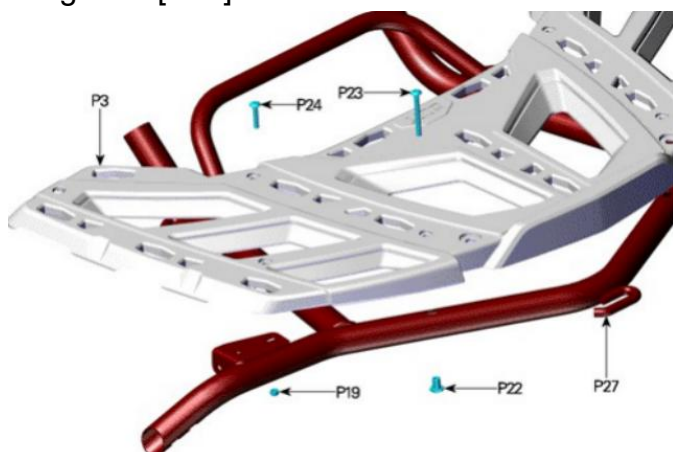

6. Repeat with the remaining M6 X 35 torx screw [P24] and M6 elastic flange nut [P19] and three (3) remaining M6 X 65 torx [P23] screws and inserts [P22].



7. Preassemble all the assembly on the cargo rack with eight (8) M8 X 60 screws [P14], with sixteen (16) washers [P15] and eight (8) M8 nuts [P17] and hand tighten.

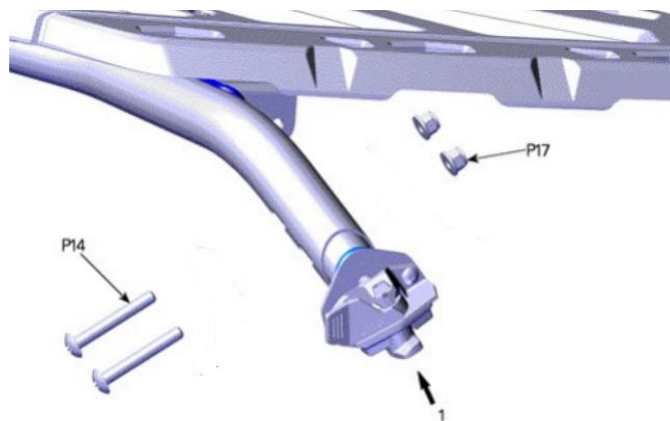

1. LinQ Assembly

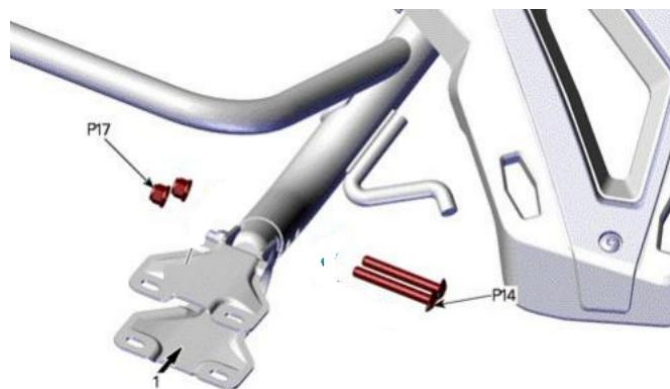

1. Upper cage attachment



UPPER CAGE ATTACHMENTS ANGLES

8. Assemble on both side of rear of vehicle the two (2) cylinder brackets [P7] with four (4) 3/16 pop- rivets [P25]. Respect position as shown in image.



# LinQ Pivoting Rack For Can-Am Maverick X3

ZP-YJ-030603-087

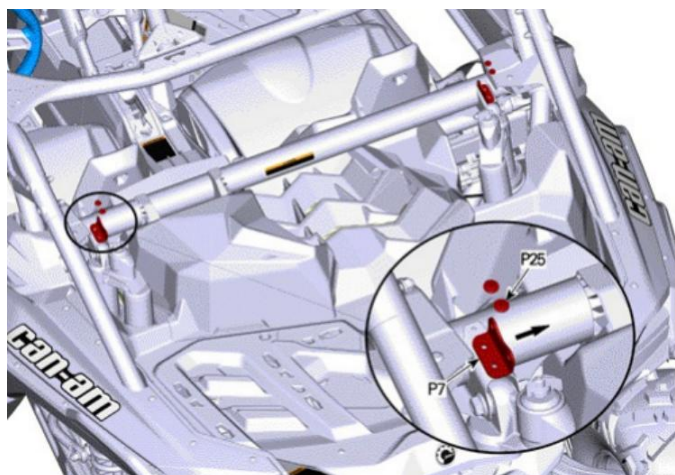

**NOTE:** If equipped with remote reservoir shocks, the two (2) rear shocks' tanks are located externally on the vehicle's rear frame. To avoid interference with the LinQ Pivoting Rack installation, modify the shocks' external tanks configuration as follow:

1. Loosen the external tank screws.
2. Turn the shocks' external tanks 90° toward the vehicle's exterior.
3. Retighten the external tank screws.

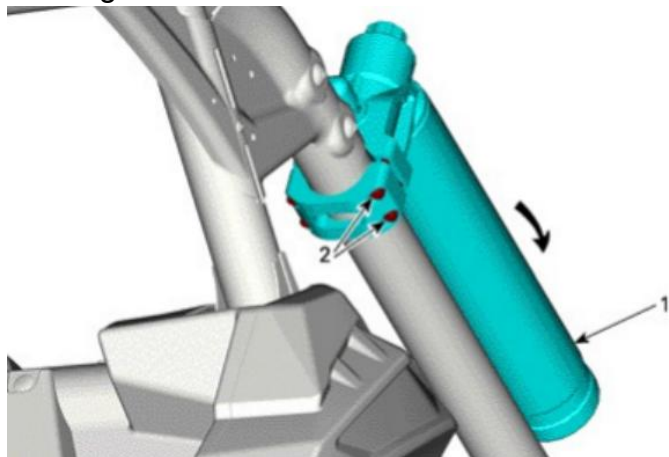

## SHOCK TANK CONFIGURATION FOR XRS

1. Shock's external tank
2. External tank screws

9. Preassemble to specified dimension A below on the frame of vehicle the four (4) LinQ tube attachment [P4] with eight (8) M6 X 30 socket head screws [P18] and eight (8) M6 nuts [P19]. Only tighten the four (4) upper screws to allow adjustment.

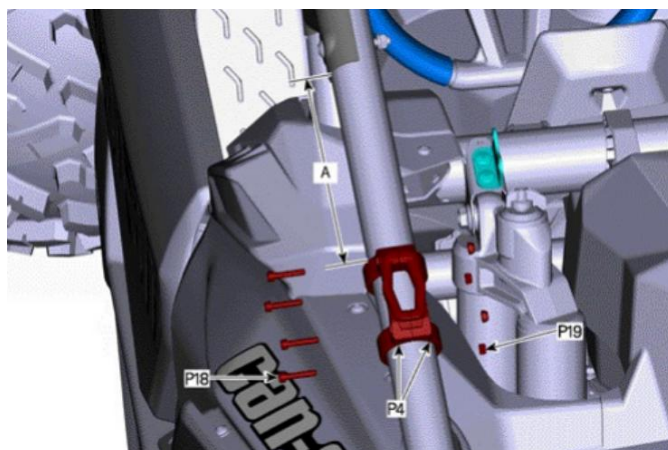

10. Pre-assemble the rack on vehicle and close LinQ lever on both sides.

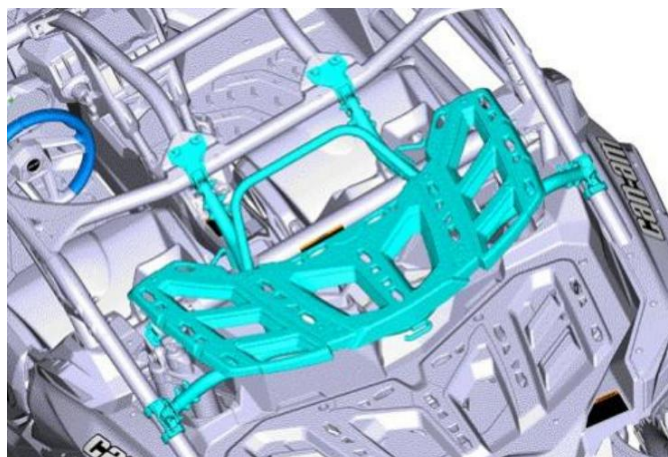

11. Install cage attachment [P30] with eight (8) M8 x 20 screws [P16] and eight (8) M8 flanged nuts [P17] to vehicle.

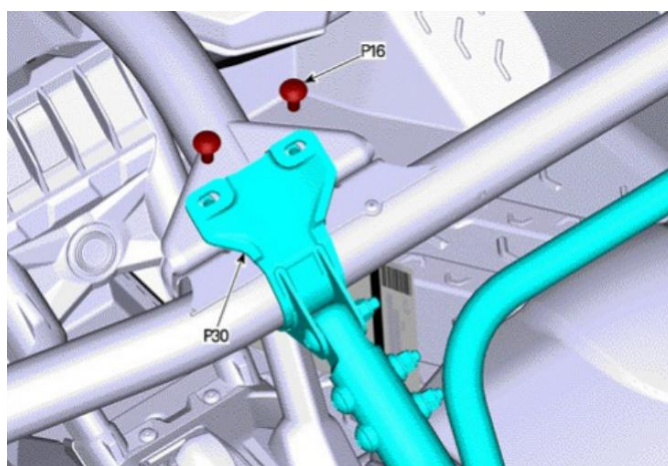

12. Adjust the LinQ attachments [P4] with the LinQ [P5] and tighten the four (4) remaining M6 X 30 screws [P18] with the four (4) M6 nuts [P19].

# LinQ Pivoting Rack For Can-Am Maverick X3

ZP-YJ-030603-087

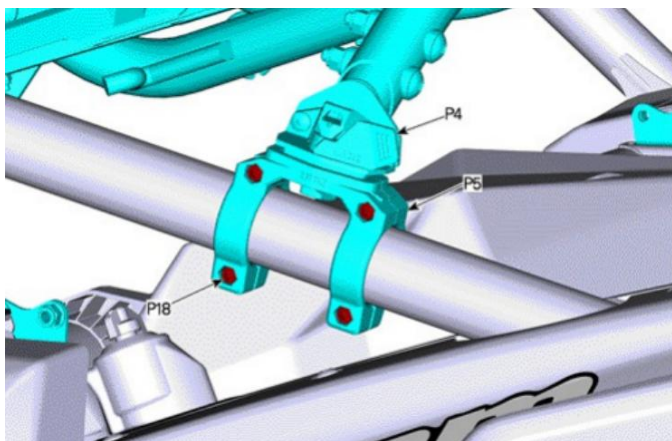

13. Tighten the eight (8) M8 X 60 adjustment screws [P14].

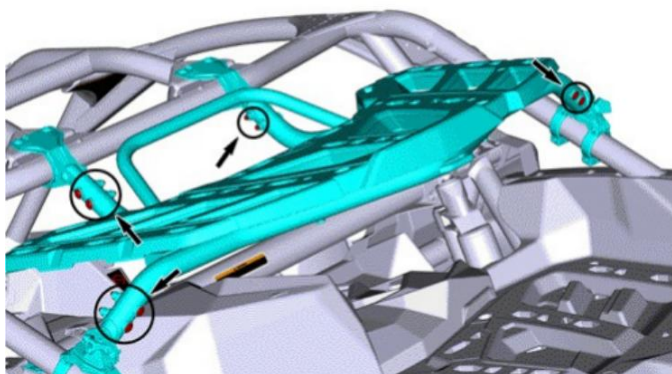

14. Open LinQ [P5] and make sure that the rack rotates freely and that the LinQ opens and latches smoothly. re-adjust if not perfect. Tighten the M5 Nuts [P19] once the adjustment is completed.

