

Combined Aluminium Roof for Polaris General 1000



ZP-YJ-030507-022

BEFORE YOU BEGIN

Read these instructions and check to be sure all parts and tools are accounted. Please retain these installation instructions for future reference.

IMPORTANT

This Aluminium Roof is exclusively designed for your vehicle. Please read the installation instructions thoroughly before beginning. Installation is easier if the vehicle is clean and free of debris.

ASSEMBLY

1. Assemble part1 and part 2 with 7 Screw – Torx Truss Head, M6 x 25 mm, 7 Washers, and 7 Rubber gaskets as shown in the figure.



INSTALLATION INSTRUCTIONS

Note: Shift vehicle transmission into “PARK”. Turn key to “OFF” position and remove from vehicle.

1. Picture of the parts

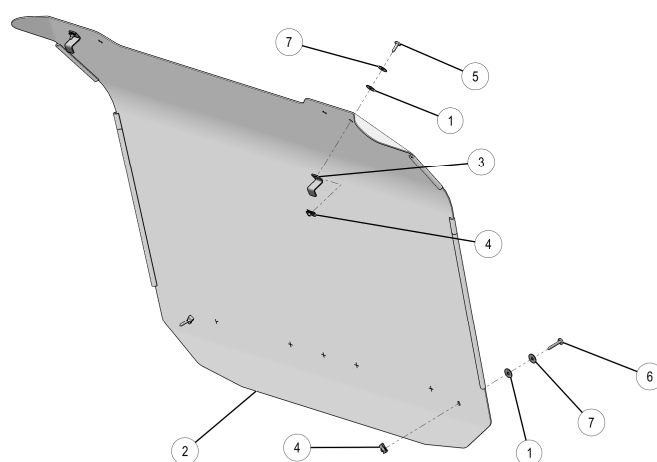

REF	QTY	PARTDESCRIPTION
1*	4	Washer, Rubber
2	1	Panel, Roof
3	2	Bracket, Roof
4*	4	Nut Clip
5*	2	Screw, Torx - M6
6*	2	Screw, Torx - M6
7*	4	Washer, Steel

2. Remove two rear screws (A) from upper visor panel as shown. Screws will not be reused.

NOTE

Do not remove forward screws. Roof will be installed on top of visor panel.

Combined Aluminium Roof for Polaris General 1000

ZP-YJ-030507-022

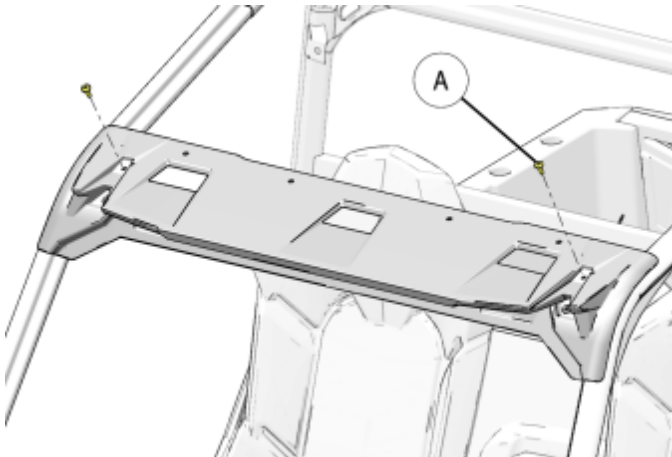

3. Optional: Replace rear nut clips (B) beneath upper visor panel as shown.

NOTE

Nut clips may be reused if in good condition, or replaced with new nut clips.

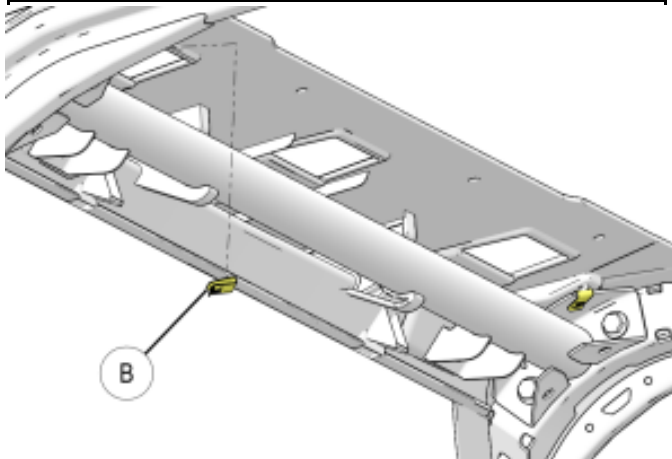

4. Install nut clips 4 to brackets 3 as shown.

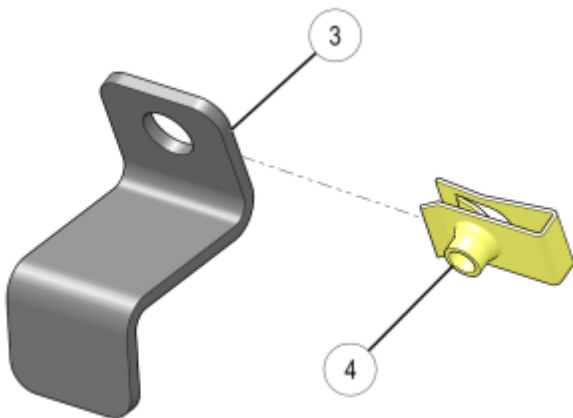

5. Loosely install screw 5 through steel washer 7, rubber washer 1, and roof 2 into nut clip and bracket assembly 3 and 4 as shown. Repeat for opposite side.

IMPORTANT

Ensure steel washer ⑦ is under screw head ⑤, and rubber washer ① is against roof ②.

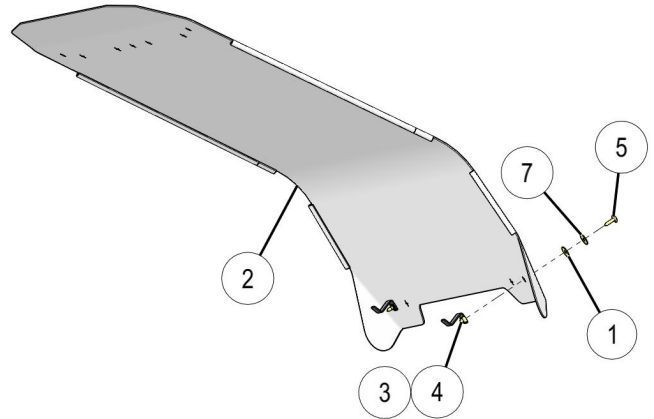

6. Position roof on ROPS, aligning front fastener holes with nut clips (B) or 4.

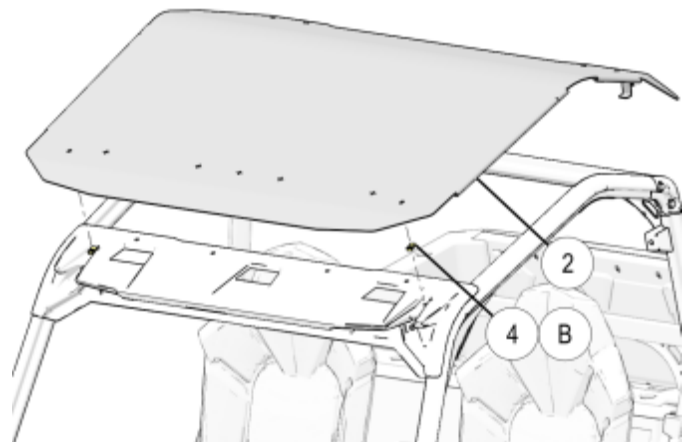

7. Loosely install screw 6 through steel washer 7, rubber washer 1, roof 2, and visor panel into nut clip (B) or 4 as shown. Repeat for opposite side.

IMPORTANT

Ensure steel washer ⑦ is under screw head ⑤, and rubber washer ① is against roof ②.

Combined Aluminium Roof for Polaris General 1000



ZP-YJ-030507-022

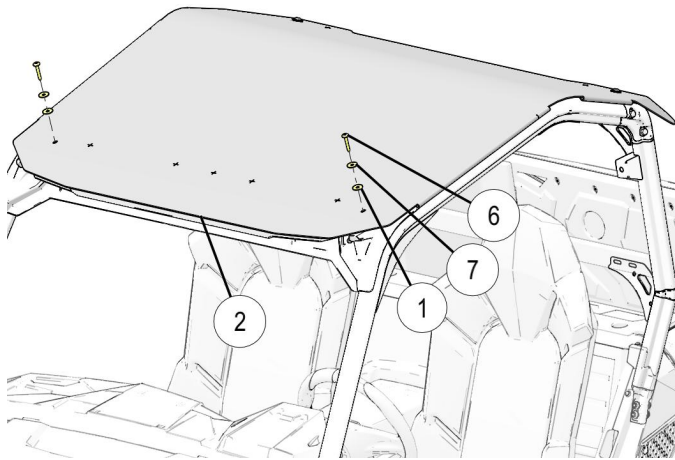

8. Rotate brackets 3 to engage rear ROPS as shown.

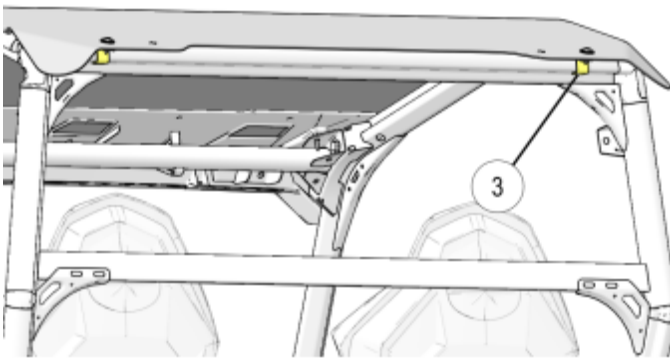

9. Torque all screws to specification.
Torque: 8 ft. lbs. (11 Nm)