

Rock Sliders for Can-Am Maverick X3

ZP-YJ-030606-005



BEFORE YOU BEGIN

Read these instructions and check to be sure all parts and tools are accounted for. Please retain these installation instructions for future reference.

IMPORTANT

These Rock Sliders are exclusively designed for your vehicle. Please read the installation instructions thoroughly before beginning. Installation is easier if the vehicle is clean and free of debris.

1. Shift vehicle transmission into "PARK". Turn key to "OFF" position and remove from vehicle.

PARTS TO BE INSTALLED



2. Connect ① and ② with four M8 lock nuts. Four M8*50 hexagon screws as shown .

Item	Description	Part number	QTY
P1	Cap	705202455	6
P2	Left Lower Protector	Not available separately	1
P3	Right Lower Protector	Not available separately	1
P4	Backing Washer	Not available separately	6
P5	M10 X 70 Flanged hexagonal screw	207507046	6

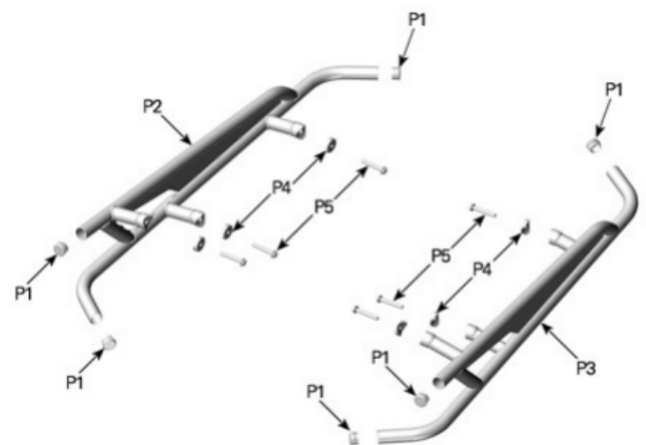

INSTALLATION INSTRUCTIONS

NOTE: Unless otherwise specified, installation instructions are the same for both sides.

1. Install cap on each end (3) of lower protectors [P2] and [P3].

2. Locate marks on rear and central lateral panel. Drill 45 mm (1.75 in) holes on marks with 1-3/4" hole saw.

NOTICE: Drill perpendicular to the plastic surface. The two (2) lower holes will be drilled slightly at an angle.



DRILL PERPENDICULAR TO THE SURFACE

3. Trim extra plastic edge.

Rock Sliders for Can-Am Maverick X3

ZP-YJ-030606-005



4. Install left lower protector [P2].



5. Secure with three (3) M10 x 70 hexagonal flanged cap screws [P5] and three (3) saddle washers [P4].

- Front anchor point: from underneath through skid plate
- Central anchor point: between seat and body
- Rear anchor point: From behind seat. Move forward seat all the way front. Cut cabin where

Prior to installing M10 x 70 hexagonal flanged cap screws [P5] at front anchor point, trim a rib in the floor to allow passage of the bolt.

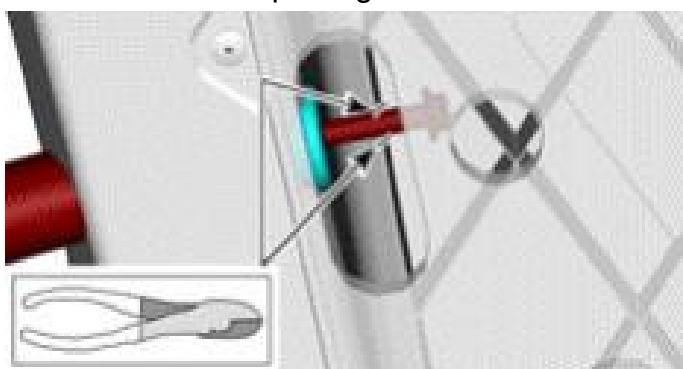

USE CUTTER PLIERS TO CUT FLOOR RIB

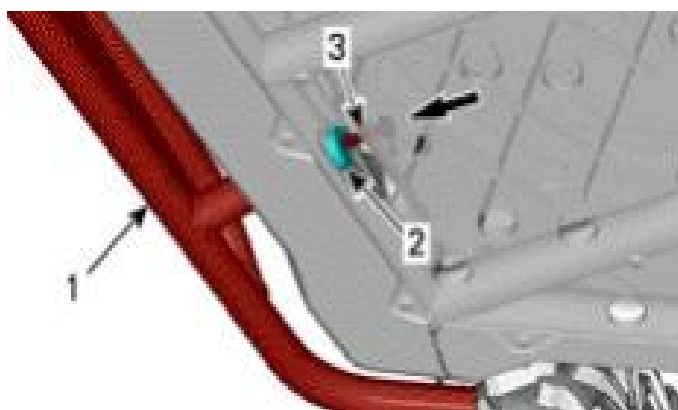

FRONT ANCHOR POINT

1. Left lower protector [P2]
2. Saddle washer [P4]
3. M10 x 70 hexagonal flanged cap screw [P5]

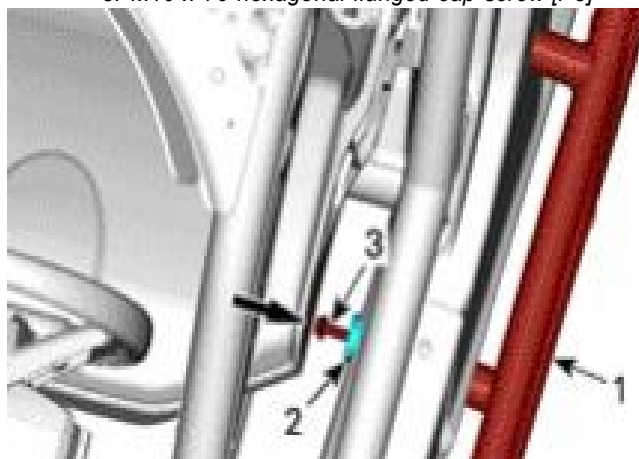

CENTER ANCHOR POINT

1. Left lower protector [P2]
2. Saddle washer [P4]
3. M10 x 70 hexagonal flanged cap screw [P5]

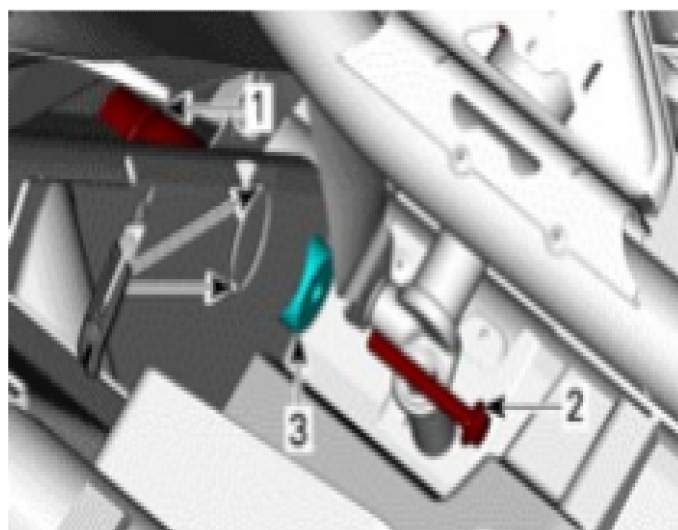

REAR ANCHOR POINT

1. Left lower protector [P2]
2. Saddle washer [P4]
3. M10 x 70 hexagonal flanged cap screw [P5]