

INSTALLATION INSTRUCTIONS

UNDER DASH STORAGE

PARTS LIST

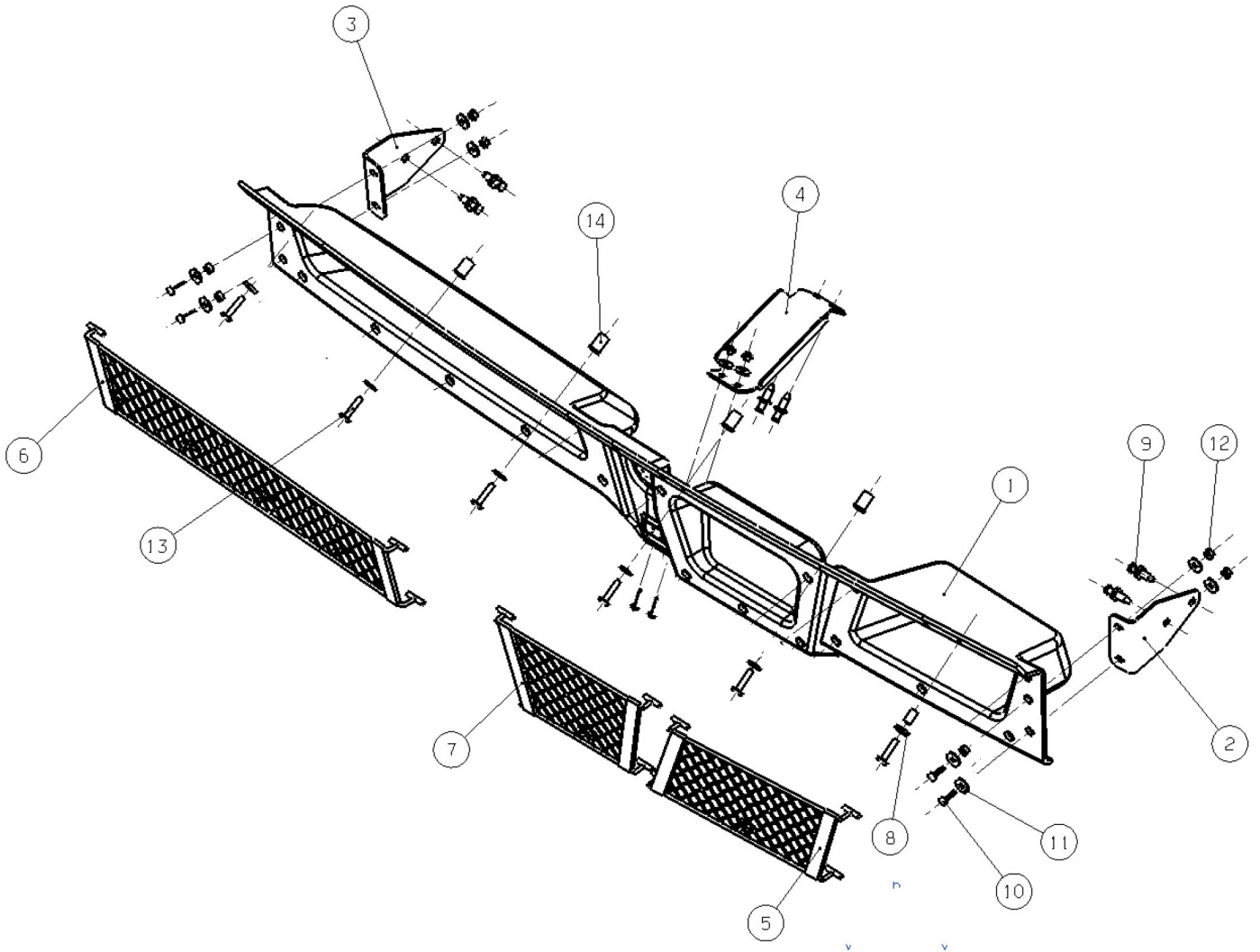

No.	Description	Qty
(1)	Under dash storage	1
(2)	Right bracket	1
(3)	Left bracket	1
(4)	Center bracket	1
(5)	Right net	1
(6)	Left net	1
(7)	Center net	1
(8)	Collar A/ 11.8 mm	2

No.	Description	Qty
(9)	Trim clip	6
(10)	Pan screw 6 x 20 mm	6
(11)	M6 Plain washer	18
(12)	Hex nut	6
(13)	Pan screw 6 x 28	6
(14)	Well nut	4

TOOLS AND SUPPLIES REQUIRED

4 mm allen wrench
10 mm wrench
Power drill
12mm drill bit
8mm drill bit
Marker
Needle nose pliers

TORQUE CHART

Tighten all screws, bolts, and nuts to their specified torque values.

Item	N-m	kgf-m	lbf-ft
Well nut bolt	1	0.1	0.7
6 mm bolt	10	1.0	7.4

USE AND CARE INFORMATION

Check the accessory mounts frequently and retighten if necessary.

INSTALLATION

1. Install the right, left, and center nets in the locations shown by using needle nose pliers to guide the brass fitting through the plastic parts

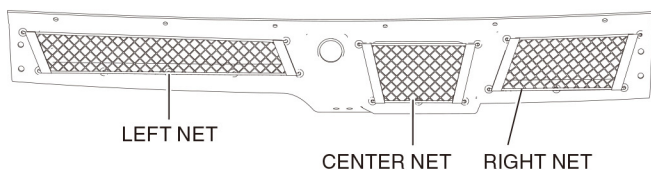

2. Remove the four trim clips and two pan screws from the front lower area of the instrument panel.

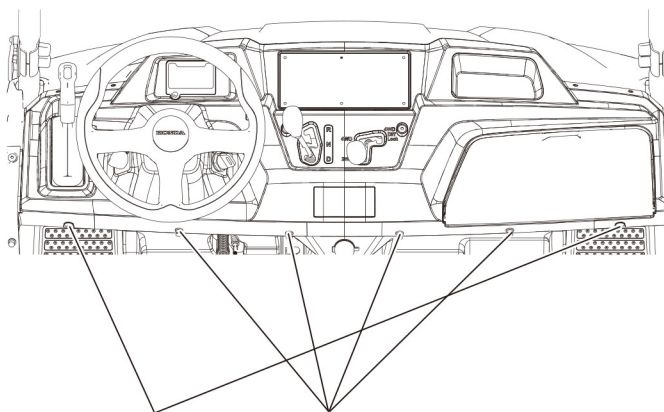

PAN SCREW 6 X 8 TRIM CLIP

3. Drill out the center four holes with a 12mm drill bit as shown.

NOTICE: When drilling the right hole, be careful not to drill beyond the instrument panel as the glove box could be damaged.

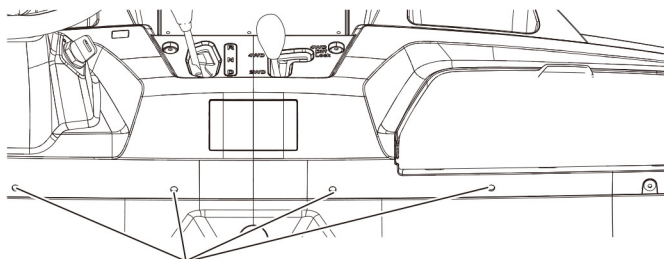

DRILL

4. Press the four well nuts into the holes drilled in Step 4.

NOTE: Flange of well nut should be on outside of the instrument panel.

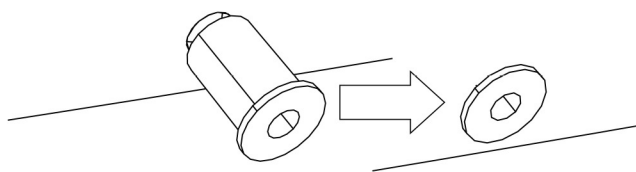

5. Install the left and right brackets as shown using:

- a. (4) Pan screw 6 x 20 mm
- b. (4) M6 Plain washer
- d. (4) M6 Plain washer
- e. (4) Hex nut

Tighten the bolts to the specification in the Torque Chart.

RIGHT SIDE

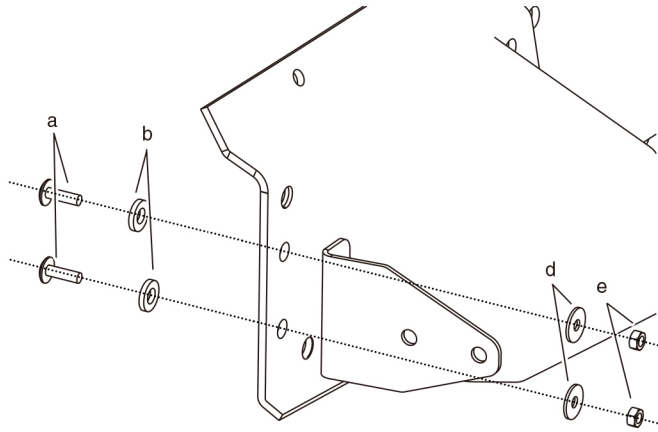

LEFT SIDE

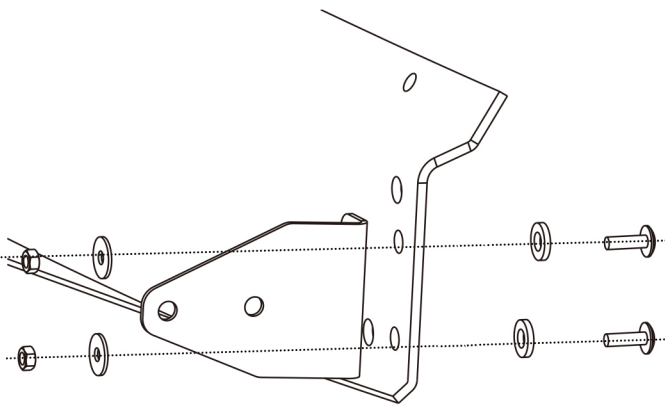

6. Install the center bracket to under dash storage as shown below using:

- a. (2) Pan screw 6 x 20
- b. (2) M6 Plain washer
- d. (2) M6 Plain washer
- e. (2) Hex nut

Tighten the hardware to the specification in the Torque Chart.

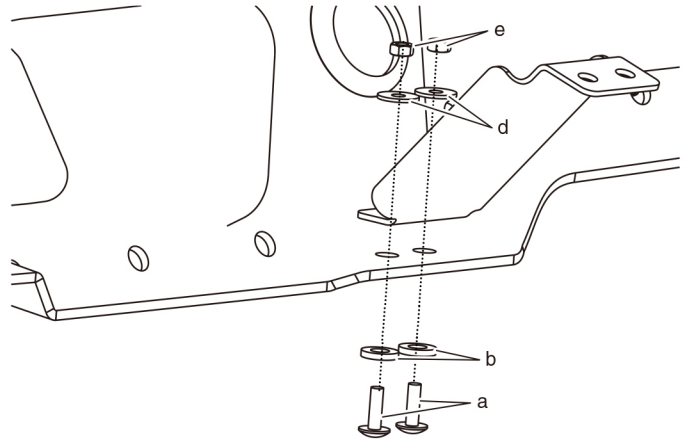

7. Temporarily install the under dash storage partial assembly onto the instrument panel and secure the upper corners as shown using:

- a. (2) Pan screw 6 x 28
- b. (2) M6 Plain washer
- c. (2) Collar A/11.8 mm collar

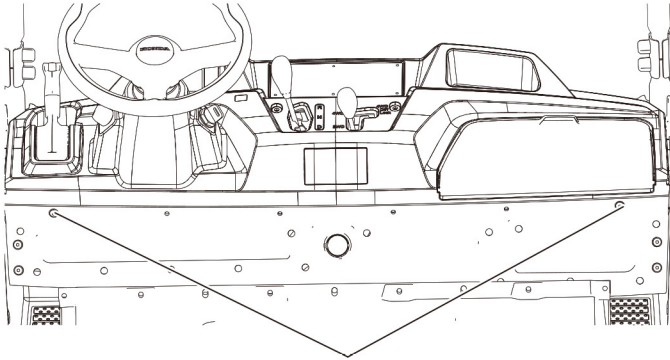

CORNER FASTENER

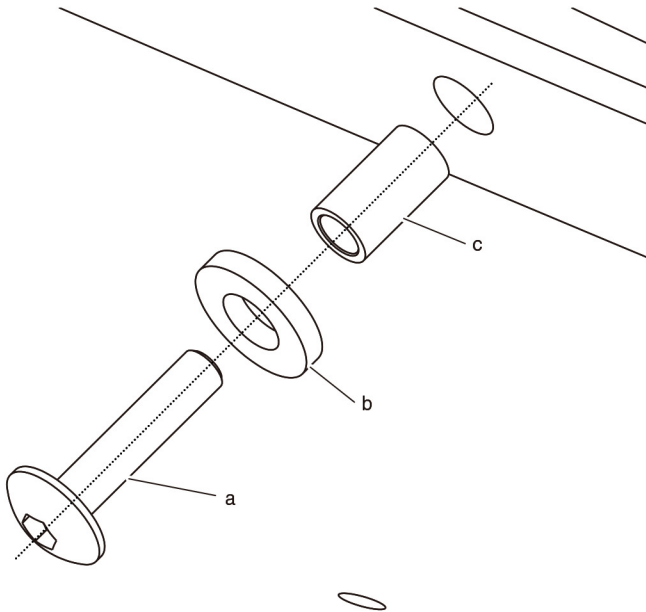

8. Use the left, center, & right brackets as templates to mark the position of holes to be drilled in the floor cover.

LEFT and CENTER BRACKETS

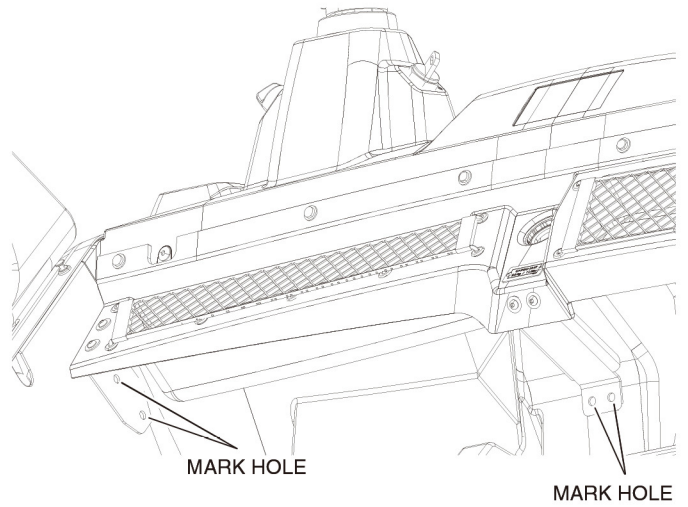

RIGHT BRACKET

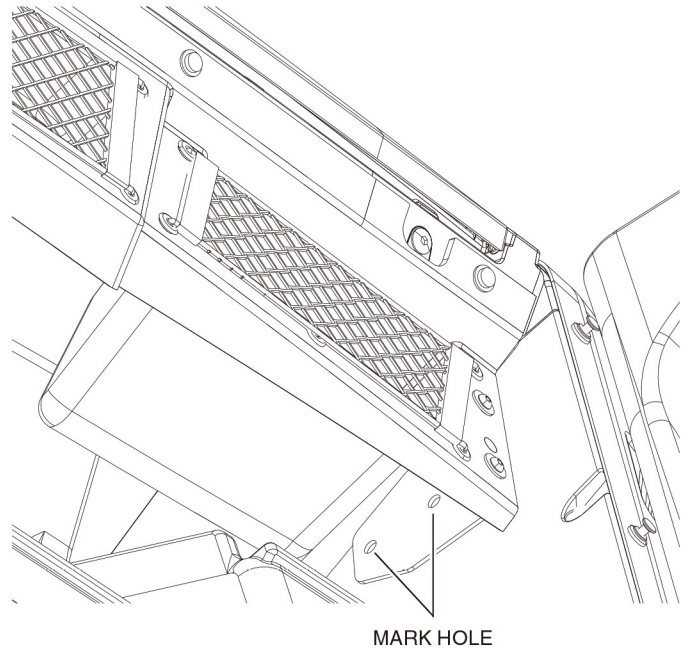

9. Remove parts that were installed in step 8 and remove under dash storage partial assembly.

10. Using 8mm drill bit, drill holes in the floor cover at the positions marked in Step 9.

11. Reinstall the under dash storage partial assembly as shown in Step 8.

12. Install the center fasteners through the under dash storage as shown using:

- a. (4) Pan screw 6 x 28 mm
- b. (4) M6 Plain washer

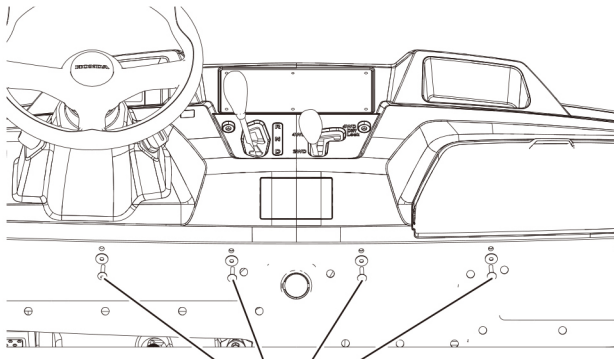

PLAIN WASHER/PAN SCREW

13. Install the six trim clips through the bracket into the six holes that were drilled in Step 11.

RIGHT SIDE

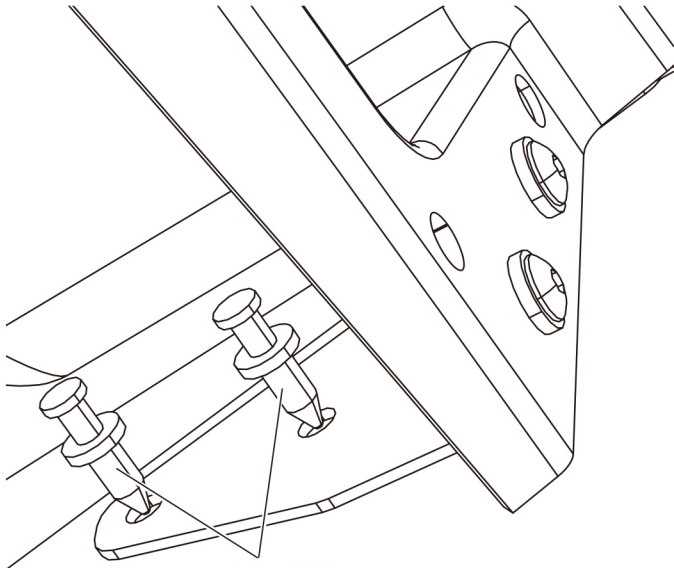

TRIM CLIP

LEFT SIDE

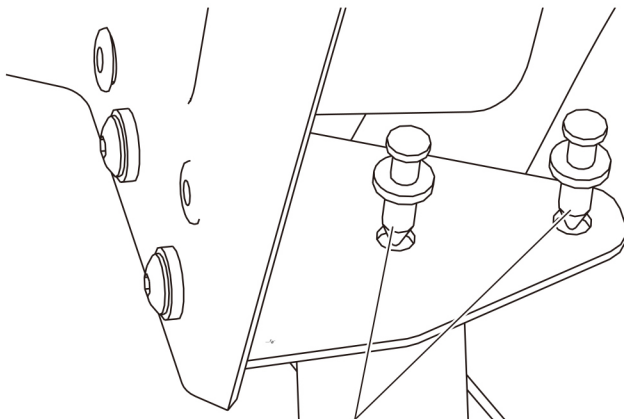

TRIM CLIP

CENTER

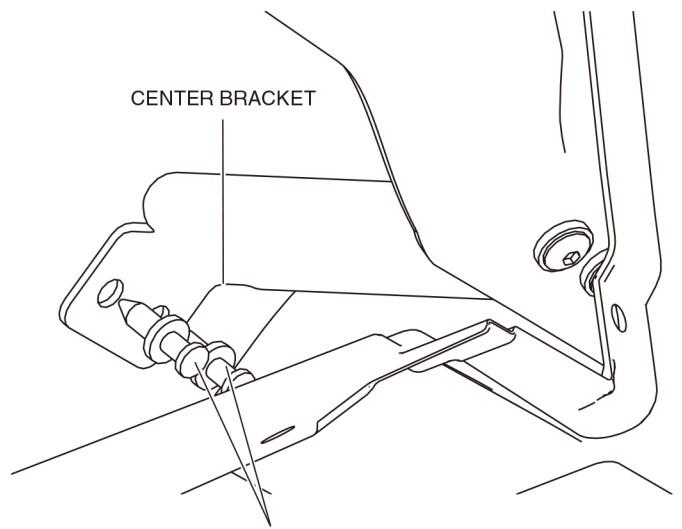

TRIM CLIP

14. Tighten the hardware to the specification in the Torque Chart.