

# Door Mounted Side Mirrors Kit for Polaris Ranger XP 1000



ZP-YJ-030505-029

## BEFORE YOU BEGIN

Read these instructions and check to be sure all parts and tools are accounted. Please retain these installation instructions for future reference.

## IMPORTANT

These *Door Mounted Side Mirrors Kit* are exclusively designed for your vehicle. Please read the installation instructions thoroughly before beginning. Installation is easier if the vehicle is clean and free of debris.

## INSTALLATION INSTRUCTIONS

### Tools Required

Safety Glasses	Center Punch
Drill /Drill Bit:	Scissors
1/2 in (13 mm)	Socket Set, Metric
1/8 in (3 mm)	Socket Set, SAE
11/32 in (9 mm)	Socket Set, Torx Bit

### Product picture

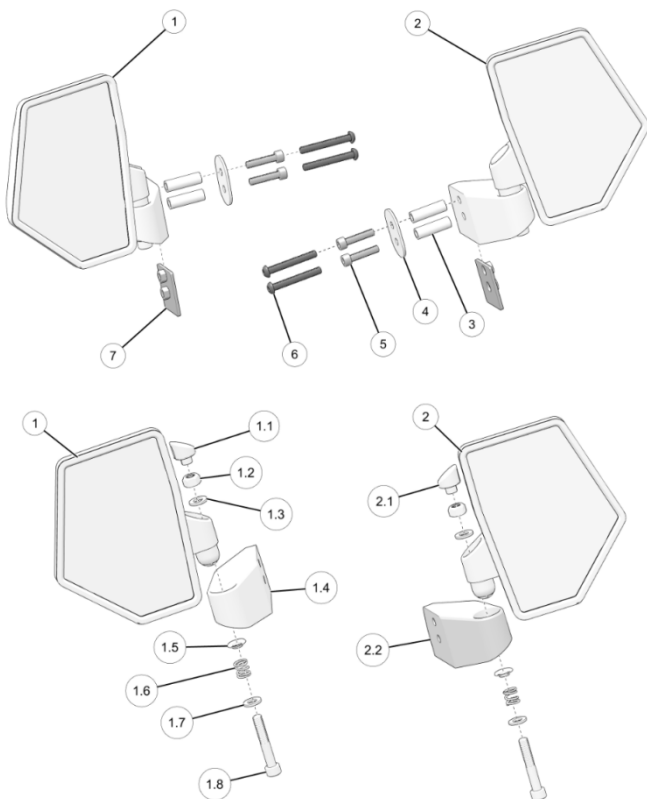

PART No.	PART DESCRIPTION	QTY
1	Mirror Assembly, Left	1
1.1	- Mirror Bolt Cap, Left	1
1.2	- Nut, M10	1
1.3	- Rubber Washer	2
1.4	- Mirror Base, Left	1
1.5	- Spring Mount Spacer	2
1.6	- Compression Spring	2
1.7	- Washer, M10	2
1.8	- Screw, Socket Head, (M10 x 60 mm)	2
2	Mirror Assembly, Right	1
2.1	- Mirror Bolt Cap, Right	1
2.2	- Mirror Base, Right	1
3	Spacer, (0.5 OD x 8.5 ID x 4 mm)	4
4	Mirror Backer Plate	2
5	Screw, Socket Head, (M8 x 35 mm)	4
6	Screw, Button Head Hex, (M8 x 1.25 x 60 mm)	4
7	Backer Plate, Weld Nut	2
8	Door Mirror Templates (not shown)	1

# Door Mounted Side Mirrors Kit for Polaris Ranger XP 1000



ZP-YJ-030505-029

**Notice:** Park vehicle on a flat surface and shift vehicle transmission into “PARK”. Turn key to “OFF” position and remove from vehicle.

## Prepare Template:

1. Cut out template along outer border.

## Prepare Doors:

Ranger 1000 and XP 1000 Models

### Notice

Left side shown; Right side similar.

1. Tape outer skin template to outside edge of driver side front door, as shown.

### Important

Make sure template curve aligns with door curve.

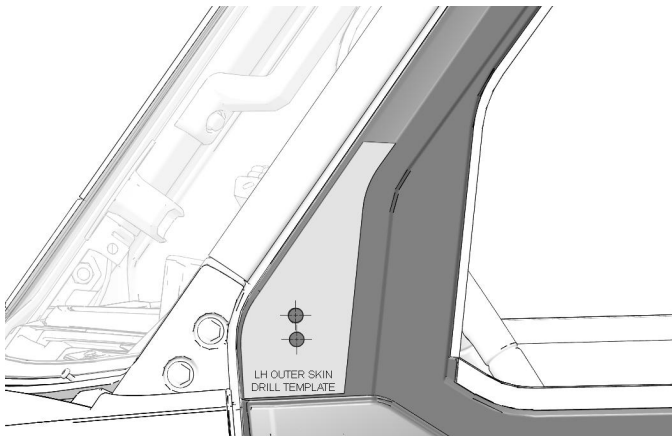

2. Tape inner skin template to inside edge of driver side door, as shown.

### Important

Make sure template curve aligns with door curve.

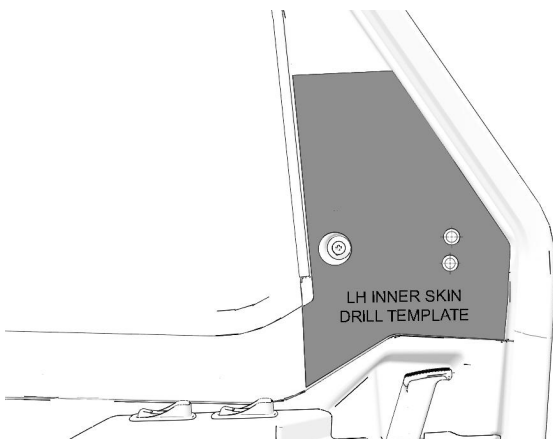

3. Align bolt cut-out on template over the bolt on the inside of door.

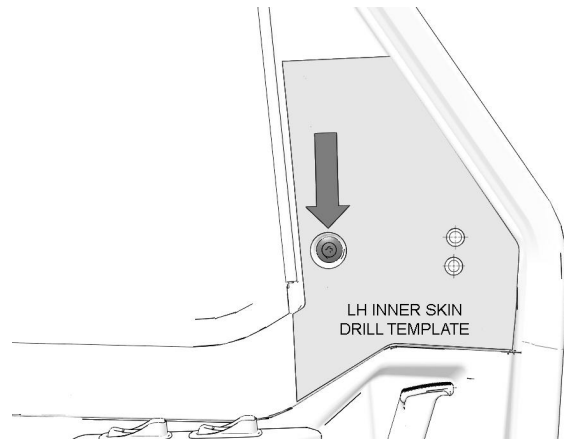

4. Mark each template cross-hair with center punch.
5. Remove paper templates.
6. Drill pilot hole through the center of each marked location on the outside of door.

### Notice

Do not drill straight through entire door. To prevent misalignment of spacer holes, drill each pilot hole through one layer of plastic on the outside of door.

### MEASUREMENT

Drill Bit Size: 1/8 in (3 mm)

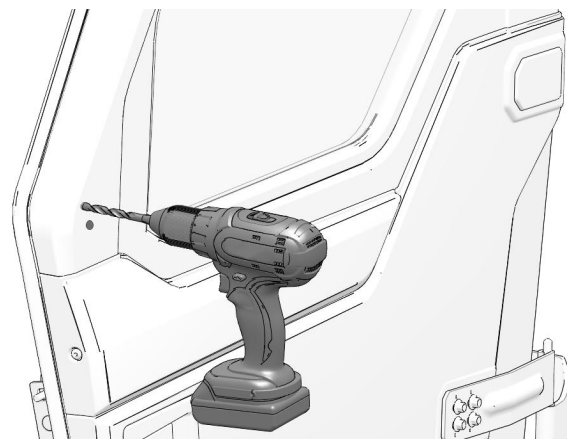

7. Drill pilot hole through the center of each marked location on the inside of door.

### Notice

Do not drill straight through entire door. To prevent misalignment of spacer holes, drill each pilot hole through one layer of plastic on the inside of door.

# Door Mounted Side Mirrors Kit for Polaris Ranger XP 1000



ZP-YJ-030505-029

## MEASUREMENT

Drill Bit Size: 1/8 in (3 mm)

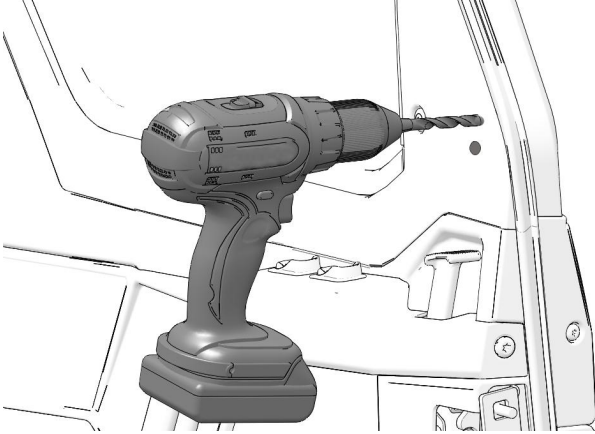

8. Drill larger spacer hole through each pilot hole on outside of door.

## Notice

Do not drill straight through entire door. To prevent misalignment of spacer holes, drill each hole through one layer of plastic on the outside of door.

## MEASUREMENT

Drill Bit Size: 1/2 in (13 mm)

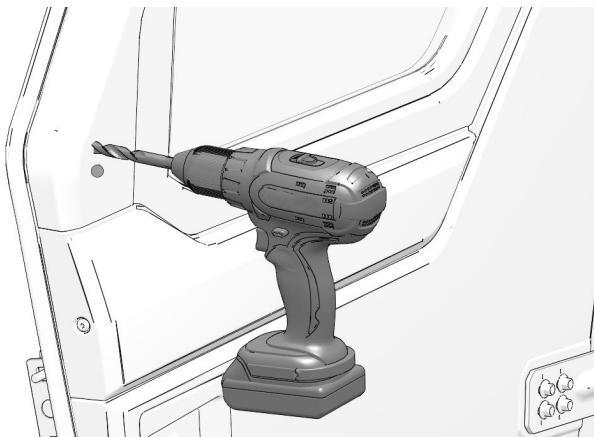

9. Drill larger spacer hole through each pilot hole on inside of door.

## Notice

Do not drill straight through entire door. To prevent misalignment of spacer holes, drill each hole through one layer of plastic on the inside of door.

## MEASUREMENT

Drill Bit Size: 1/2 in (13 mm)

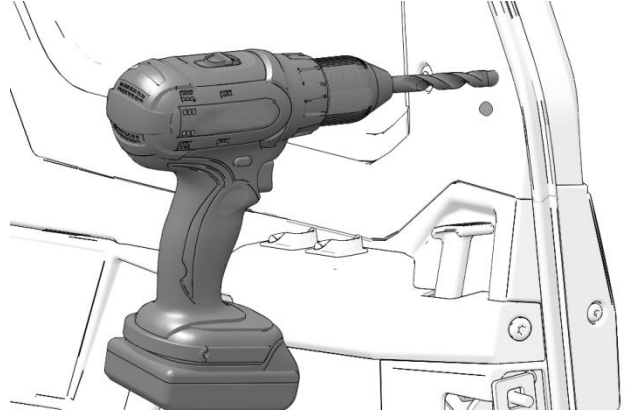

10. Repeat steps for right side front door.

## Midsized Models

1. Remove and keep two caps from inside door.

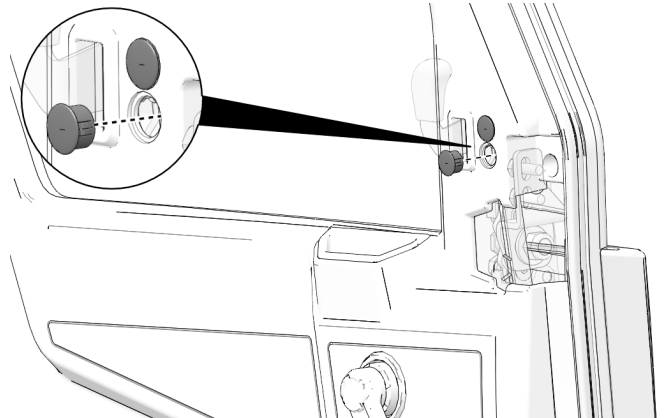

2. Drill one hole through each pre-marked indentation on the inside of the door.

## MEASUREMENT

Drill Bit Size: 11/32 in (9 mm)

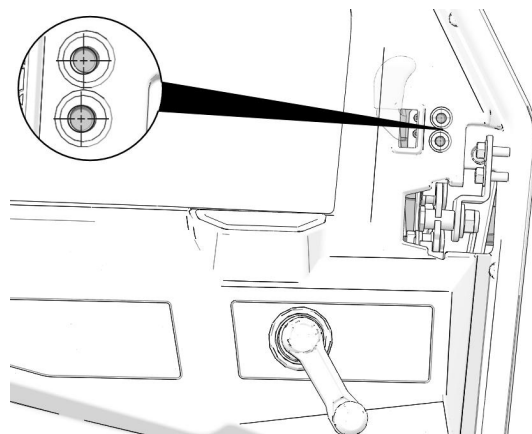

# Door Mounted Side Mirrors Kit for Polaris Ranger XP 1000



ZP-YJ-030505-029

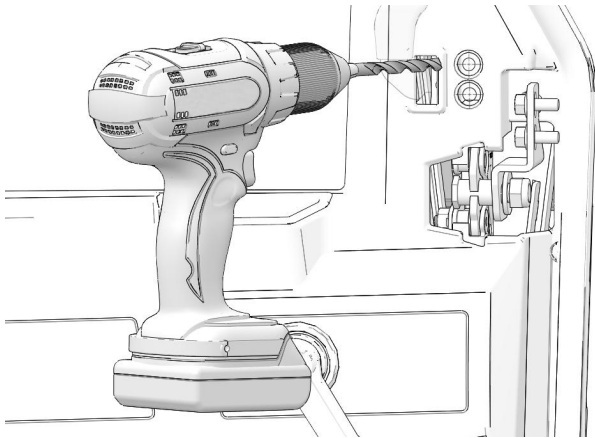

3. Slide weld nut backer plate 7 into mirror arm 1.

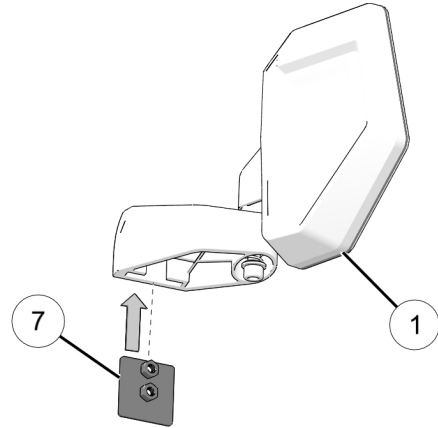

## Accessory Installation

### Ranger 1000 and XP 1000 Mirror Installation

#### Notice

Left side shown; Right side similar.

1. Install one spacer 3 into each pre-drilled hole on the door.

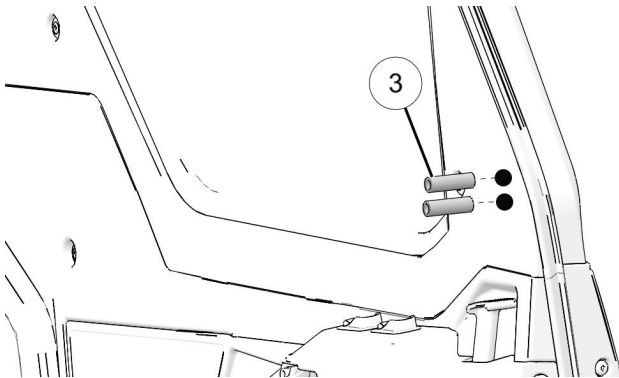

2. Install mirror backer plate 4 to the inside of the door with two screws 6 through two spacers 3.

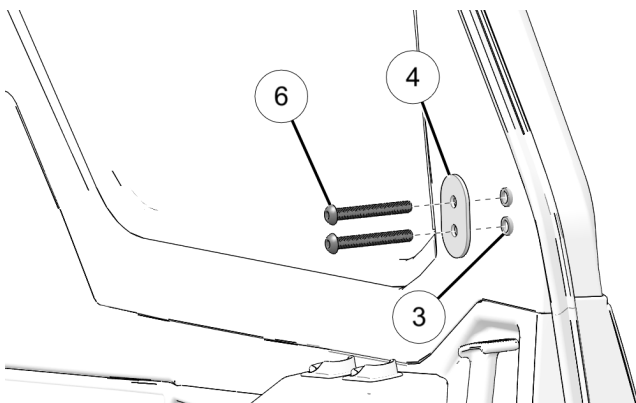

4. Install the mirror assembly 1 to the door with two screws 6.

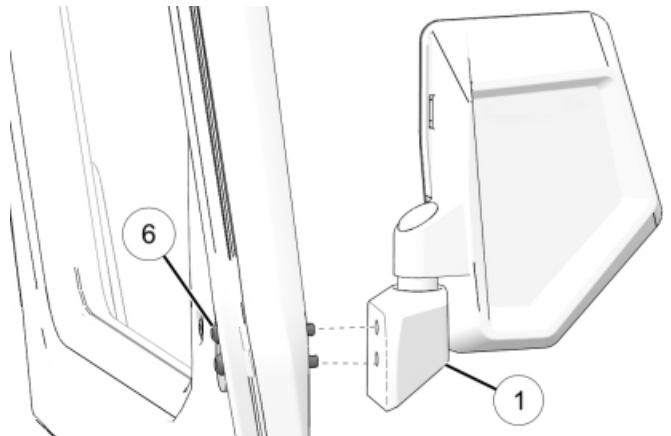

5. Torque screws to specification.

#### TORQUE

Mirror Screws 6: 14 ft-lbs (19 N·m)

# Door Mounted Side Mirrors Kit for Polaris Ranger XP 1000



ZP-YJ-030505-029

## Midsized Mirror Installation

### Notice

Left side shown; Right side similar.

1. Slide weld nut backer plate 7 into mirror arm 1.

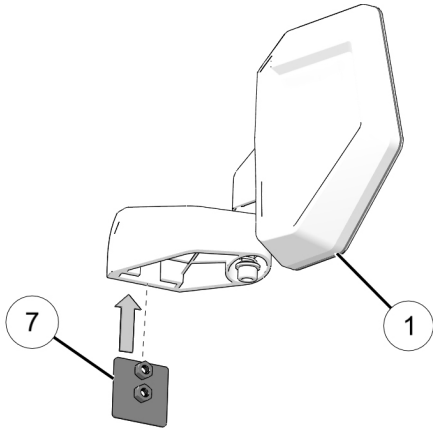

2. Install the mirror assembly 1 to the door with two screws 5.

### Notice

Install both screws through the pre-drilled holes on the inside of the door.

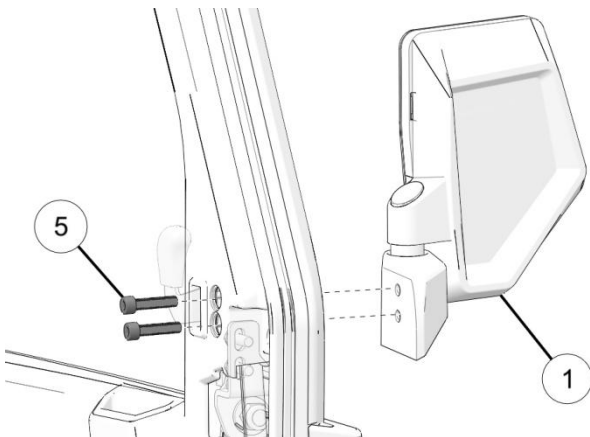

3. Torque screws to specification.

### TORQUE

Mirror Screws 5: 14 ft-lbs (19 N·m)

4. Install two kept caps to the inside of the door.

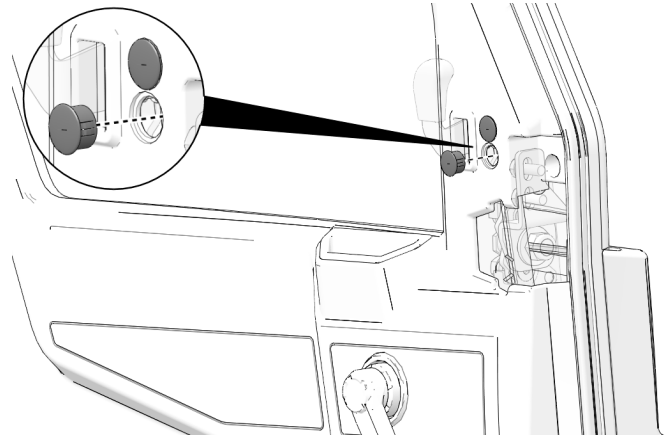

### Operation

1. Adjust mirrors for best visibility.
2. Tighten pivot bolt as needed.

### Important

Mirror pivot joint is designed to give way under impact to avoid potential damage. Avoid over tightening pivot bolt when in areas or situations where mirror impacts are more likely to happen. Over tightening pivot bolts could cause damage to the side mirrors in the event of an impact.

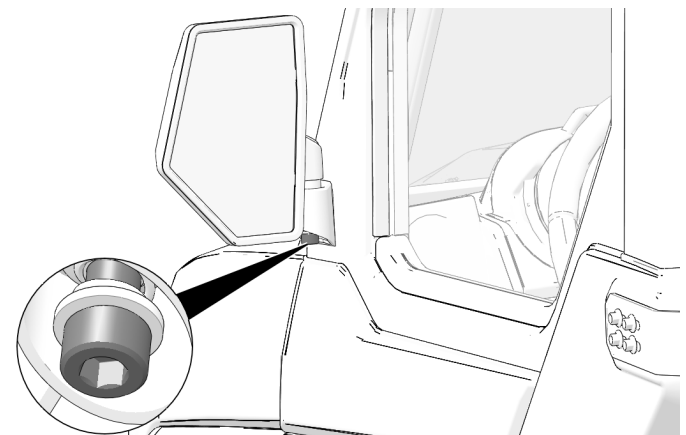

**Note:** Please refer to the installation video in the Amazon listing before your installation, or contact the seller for the installation video.