

# Sport Hood Scoop with Mesh for Honda Pioneer 700

SAUTVS®

ZP-YJ-030903-016

## BEFORE YOU BEGIN

Read these instructions and check to be sure all parts and tools are accounted. Please retain these installation instructions for future reference.

This *Sport Hood Scoop with Mesh* is exclusively designed for your vehicle. Please read the installation instructions thoroughly before beginning. Installation is easier if the vehicle is clean and free of debris.

## PRODUCT

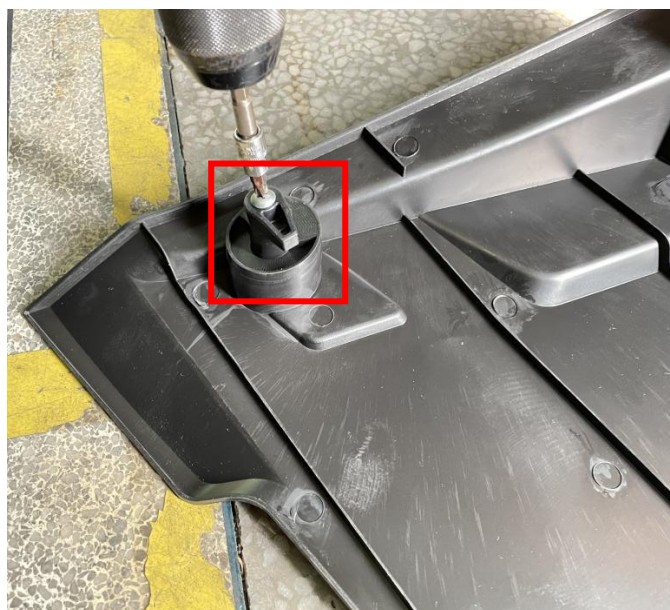
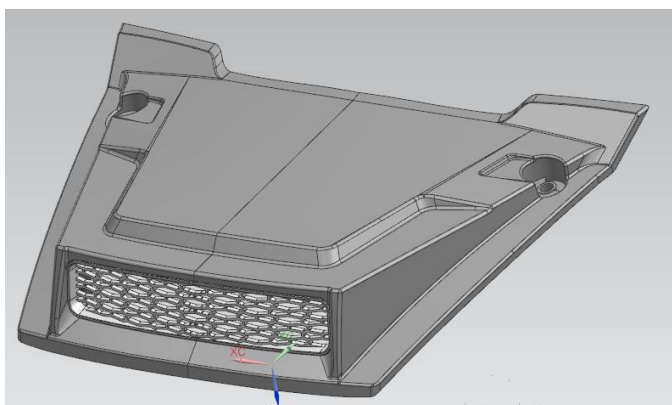

## INSTALLATION INSTRUCTIONS

1. Shift vehicle transmission into "PARK". Turn key to "OFF" position and remove from vehicle.
2. Remove the original front hood of the vehicle first, and then remove the hood clips from old and install them on the new hood scoop. As the picture shows:

3. Put the hood back on the vehicle and fasten the hood clips. The installation is complete.



# Sport Hood Scoop with Mesh for Honda Pioneer 700

ZP-YJ-030903-016

SAUTV5



**Note:** Please refer to the installation video in the Amazon listing before your installation, or contact the seller for the installation video.